

2

Inverness

	1993	1993
	1993	£22,200

THE ANCIENT MONUMENTS AND
ARCHAEOLOGICAL AREAS ACT 1979

Entry in the Schedule of Monuments

1993

Re: The Monument known as
Nunton, St Mary's Chapel
(Cladh Mhuire), chapel, Benbecula

in the Parish of South Uist and
County of Inverness

16/15

File Ref:

Solicitor
to the
Secretary of State
for Scotland
New St Andrew's House
Edinburgh

Fms 7333

THE ANCIENT MONUMENTS AND ARCHAEOLOGICAL AREAS ACT 1979
ENTRY IN THE SCHEDULE OF MONUMENTS

The monument known as Nunton, St Mary's Chapel (Cladh Mhuire), chapel, Benbecula comprises the roofless shell of a small church of late Medieval, pre-Reformation, date. The area to be scheduled comprises the chapel itself and an area of ground extending approximately 3m from its external wallface, in which evidence relating to its construction and use may survive. The area is rectangular, 13.5m E-W by 10.8m N-S. The monument, which lies in the Parish of South Uist and the County of Inverness as shown outlined in red on the Plan annexed and executed as relative hereto and which forms part of the subjects described in the

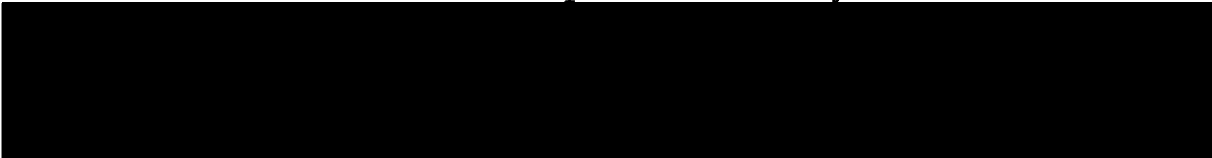

is hereby included in the Schedule of Monuments appearing to the Secretary of State for Scotland to be of national importance compiled and maintained by him under section 1(1) of the Ancient Monuments and Archaeological Areas Act 1979.

Given under the Seal of the Secretary of State for Scotland.



Assistant Secretary
Date 26 APRIL 1993

Historic Scotland
20 Brandon Street
Edinburgh
EH3 5RA

Register on behalf of the Secretary of State for Scotland in the Register of the County of Inverness.

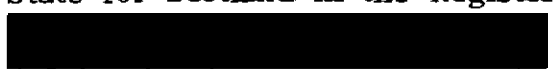

Solicitor, Edinburgh, Agent

E2101321.023

INV 93 295

REGISTERS OF SCOTLAND
GENERAL REGISTER OF SASINES
COUNTY OF INVERNESS

Fiche.....295... Frame... 30
- 1 JUN 1993
Presented and Recorded on

30

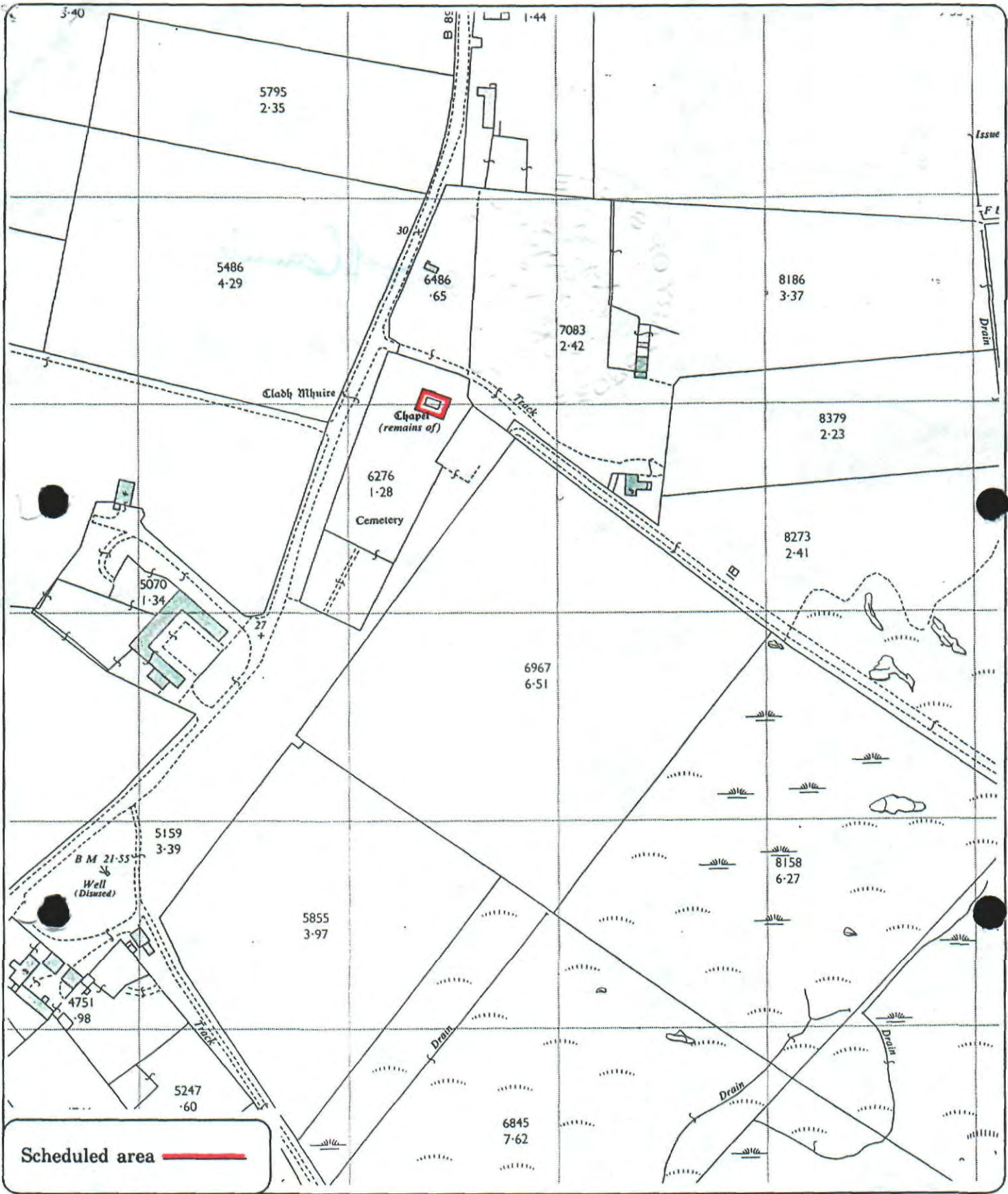

Scheduled area —

**Nunton, St Mary's Chapel
(Cladh Mhuire), chapel,
Benbecula**

South Uist Parish



Sheet : NF 75 SE

Scale : 1/2500



© Crown copyright reserved

INV 93 295

COPY BOTH SIDES 32