

THE ANCIENT MONUMENTS AND
ARCHAEOLOGICAL AREAS ACT 1979

KNC

Entry in the Schedule of Monuments

2002

Re: The Monument known as
Crab's Cairn, cairn

in the Parish of Aberdeen and
County of Aberdeen

6

2002
YEARLY NO.

1239

Search Sheet No: 4180
11779

Historic Scotland
Longmore House
Salisbury Place
Edinburgh

MFA07588

OK

4060

THE ANCIENT MONUMENTS AND ARCHAEOLOGICAL AREAS ACT 1979
ENTRY IN THE SCHEDULE OF MONUMENTS

The monument known as Crab's Cairn, cairn comprises a circular burial cairn, which measures some 14m in diameter and stands c. 1.5m in height. The cairn comprises a mound of stone of varying size. Another three cairns are located within the close vicinity, indicating that this monument may form part of a relict prehistoric funerary landscape. The area to be scheduled is a circle of diameter 40m centred on the centre of the cairn, to include the cairn and an area around it in which evidence relating to its construction and use may survive. The monument, which lies in the Parish of Aberdeen and the County of Aberdeen as shown outlined in red on the Plan annexed and executed as relative hereto and



Aberdeen, is hereby included in the Schedule of Monuments appearing to the Scottish Ministers to be of national importance compiled and maintained by them under section 1(1) of the Ancient Monuments and Archaeological Areas Act 1979.

Subscribed by Owen Kelly, Director, Properties in Care with Historic Scotland, being an officer of the Scottish Ministers at Edinburgh on the 16th day of July
Two thousand and two, before this witness Lesley Macdonald, of Longmore House, Salisbury Place, Edinburgh.



Witness

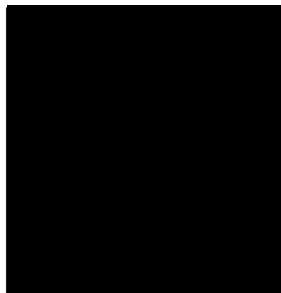

Director, Properties in Care

Register on behalf of the Scottish Ministers in the Register of the County of ^{Kincardine} Aberdeen.

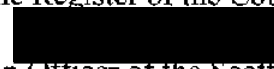

An Officer of the Scottish Ministers

KNC 0 2 MFA07788 9 7

REGISTERS OF SCOTLAND
GENERAL REGISTER OF SASINES
COUNTY OF KINCARDINE
FICHE 97 FRAME 16
PRESENTED AND RECORDED ON

22 OCT 2002

16

This is the plan referred to in the entry in the Schedule affecting
Crab's Cairn, cairn,
dated: 10/7/02 and is signed as relative thereto.

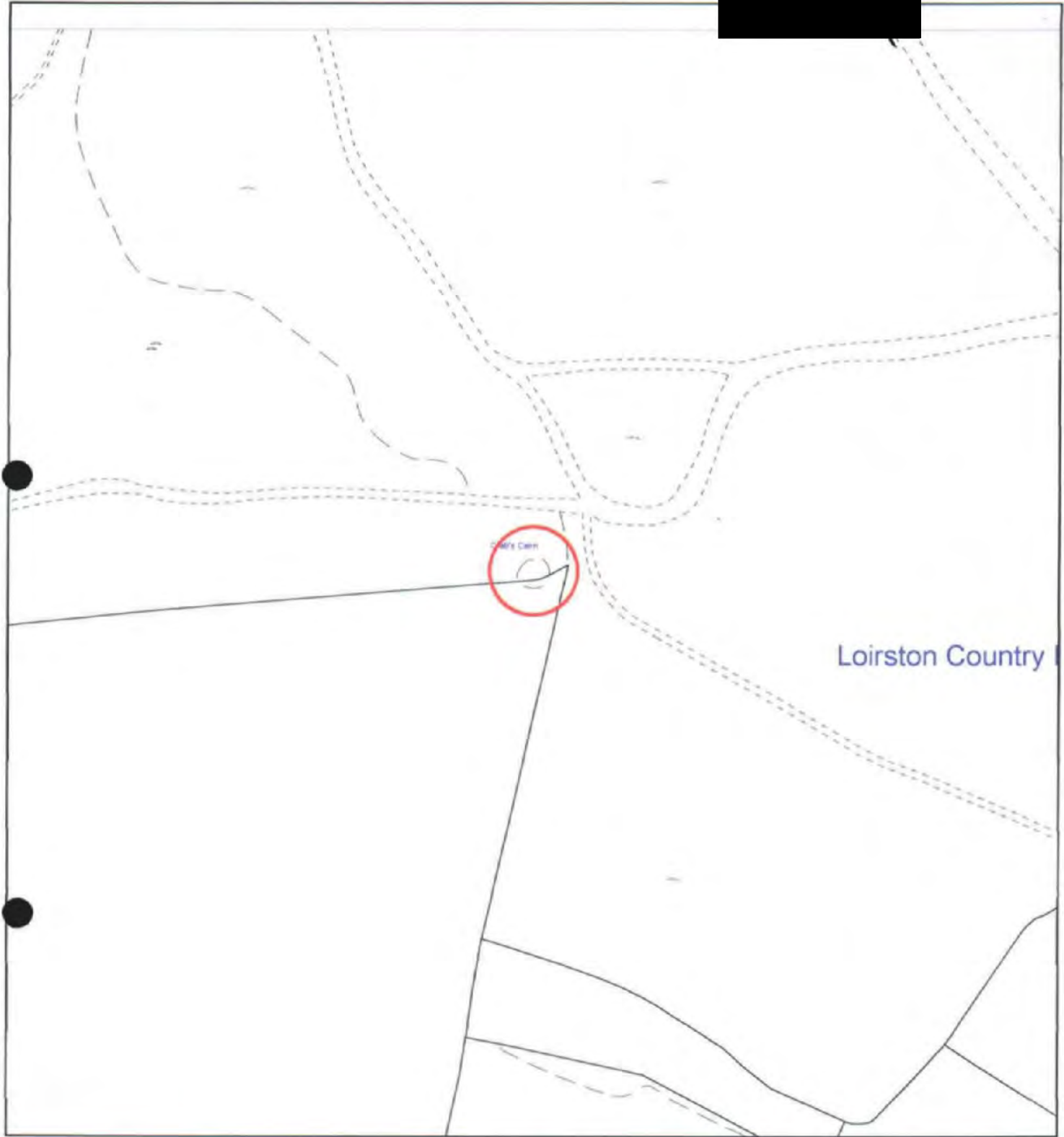
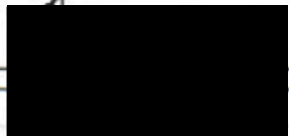

Crab's Cairn, cairn

Aberdeen Parish

Scheduled Area



N



MapSheet: NJ90SE

Scale 1:2,500

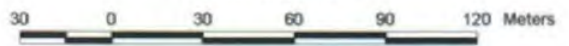

This map is reproduced from the OS map by Historic Scotland with the permission of The Controller of Her Majesty's Stationery Office, © Crown copyright. Unauthorised reproduction infringes Crown Copyright and may lead to prosecution or civil proceedings. Licence No. GD 03135G0014.