

Detail J-J - Holdfast

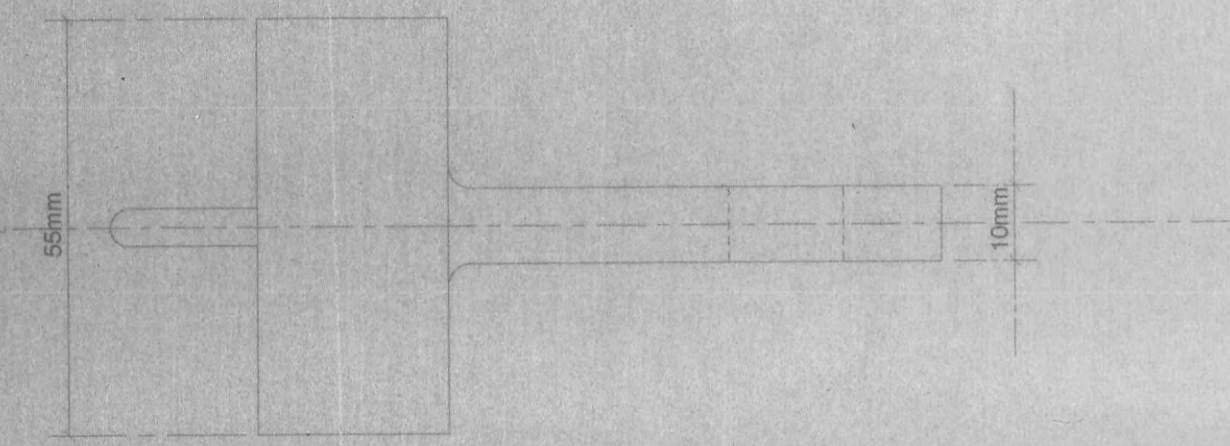

Elevation - Holder Pin



Side Elevation - Holder Pin

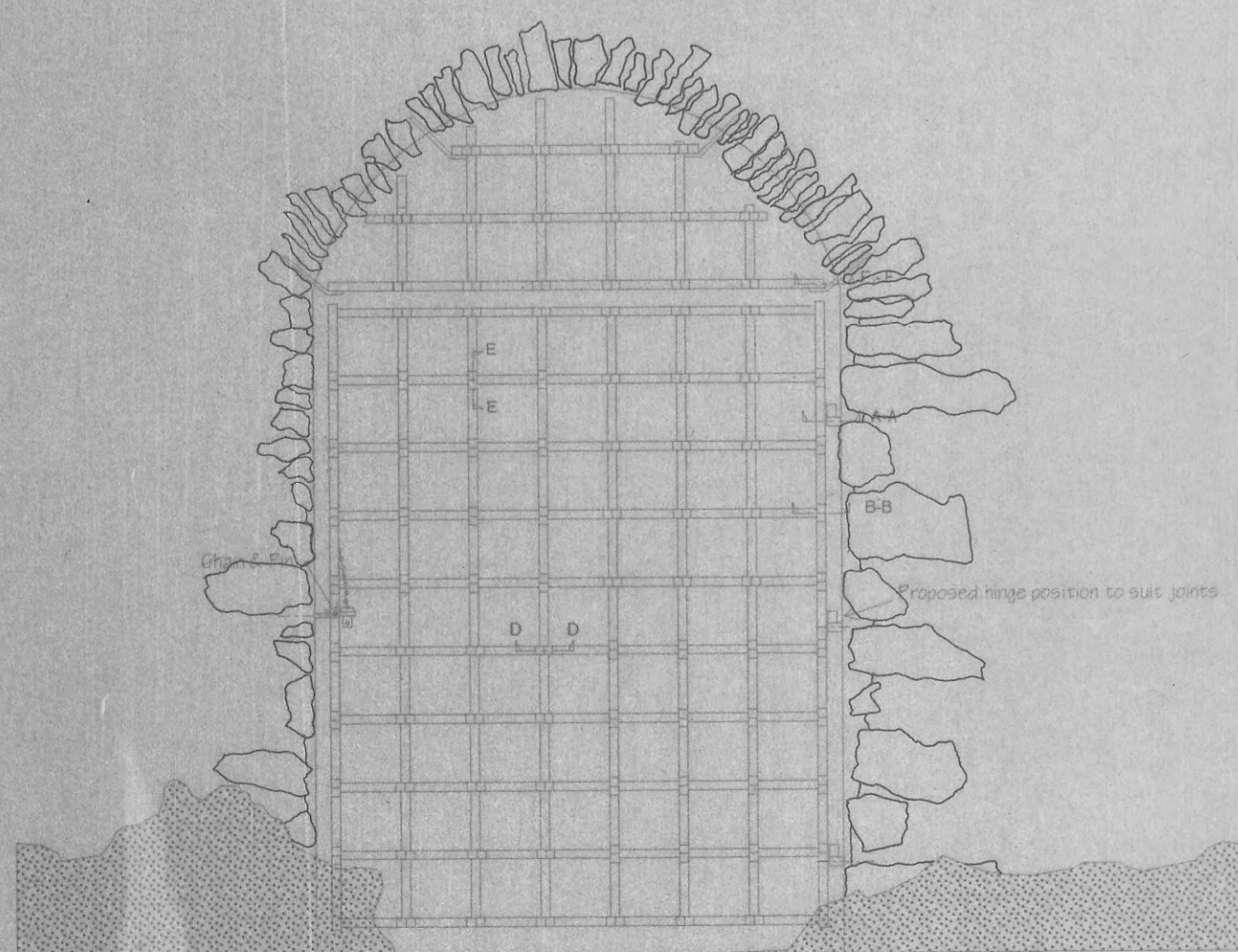

Front Elevation 1:20

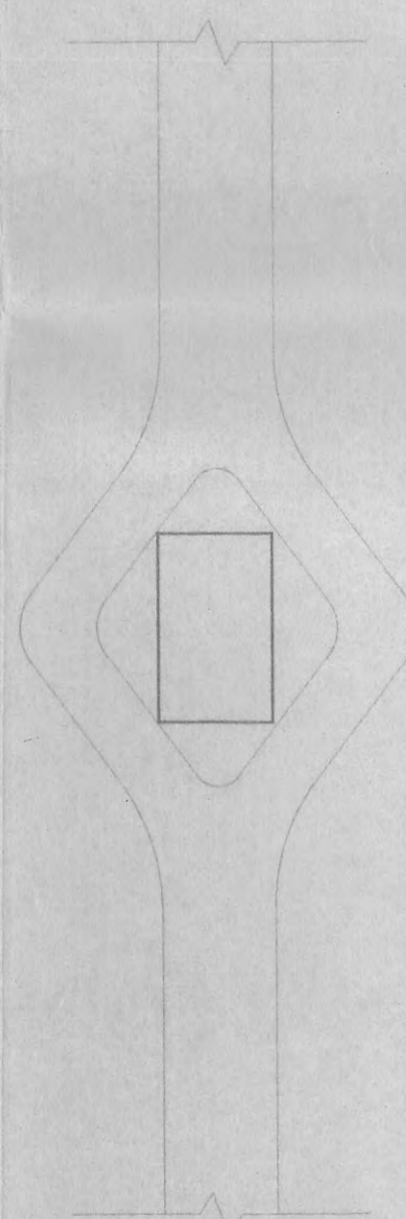

Detail E-E - Junction

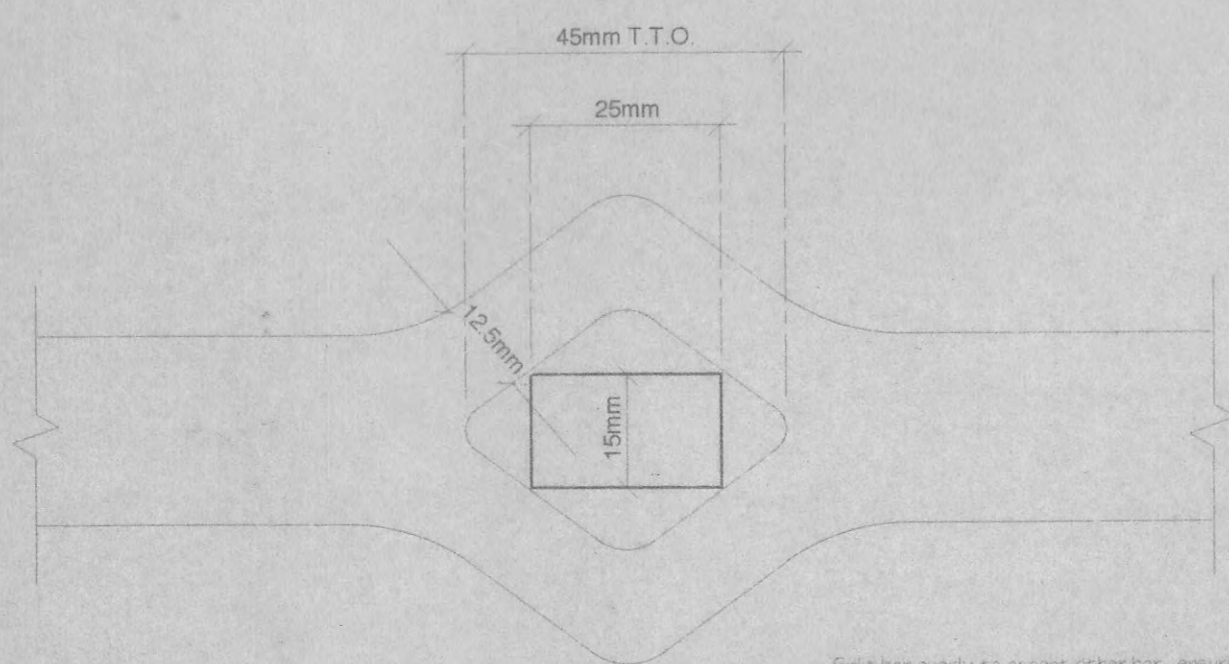

Detail D-D - Junction

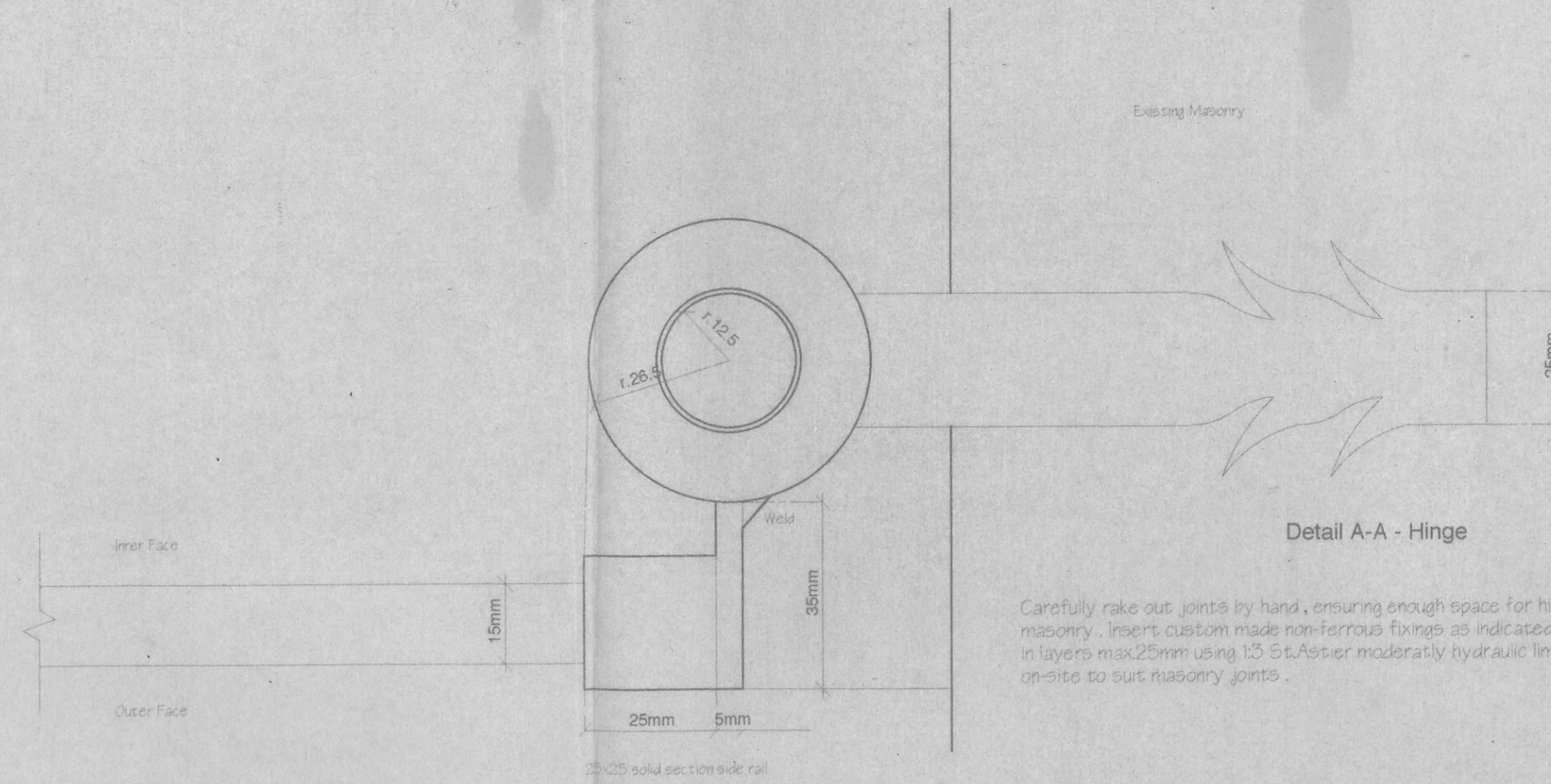

Detail A-A - Hinge

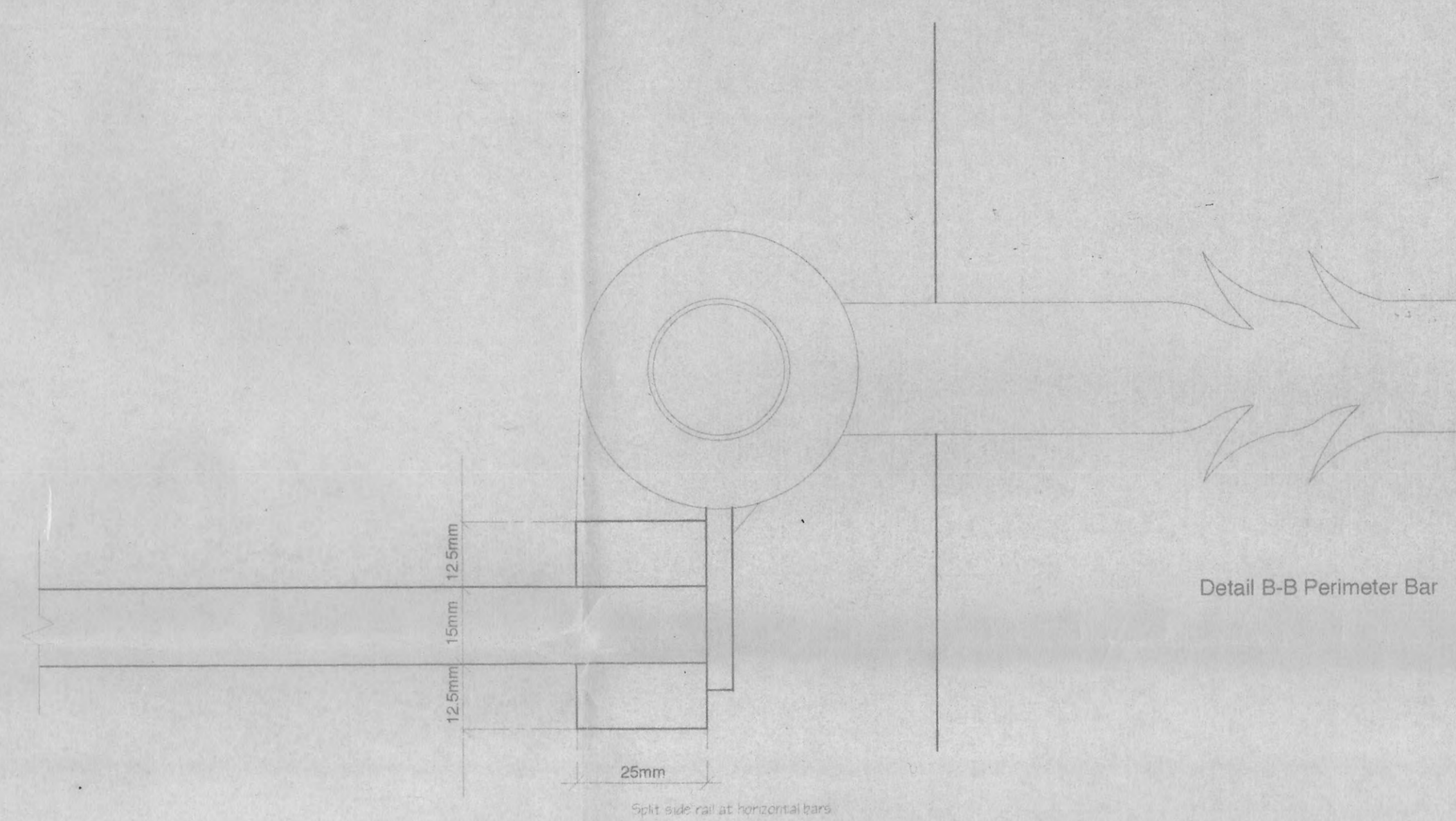

Detail B-B Perimeter Bar

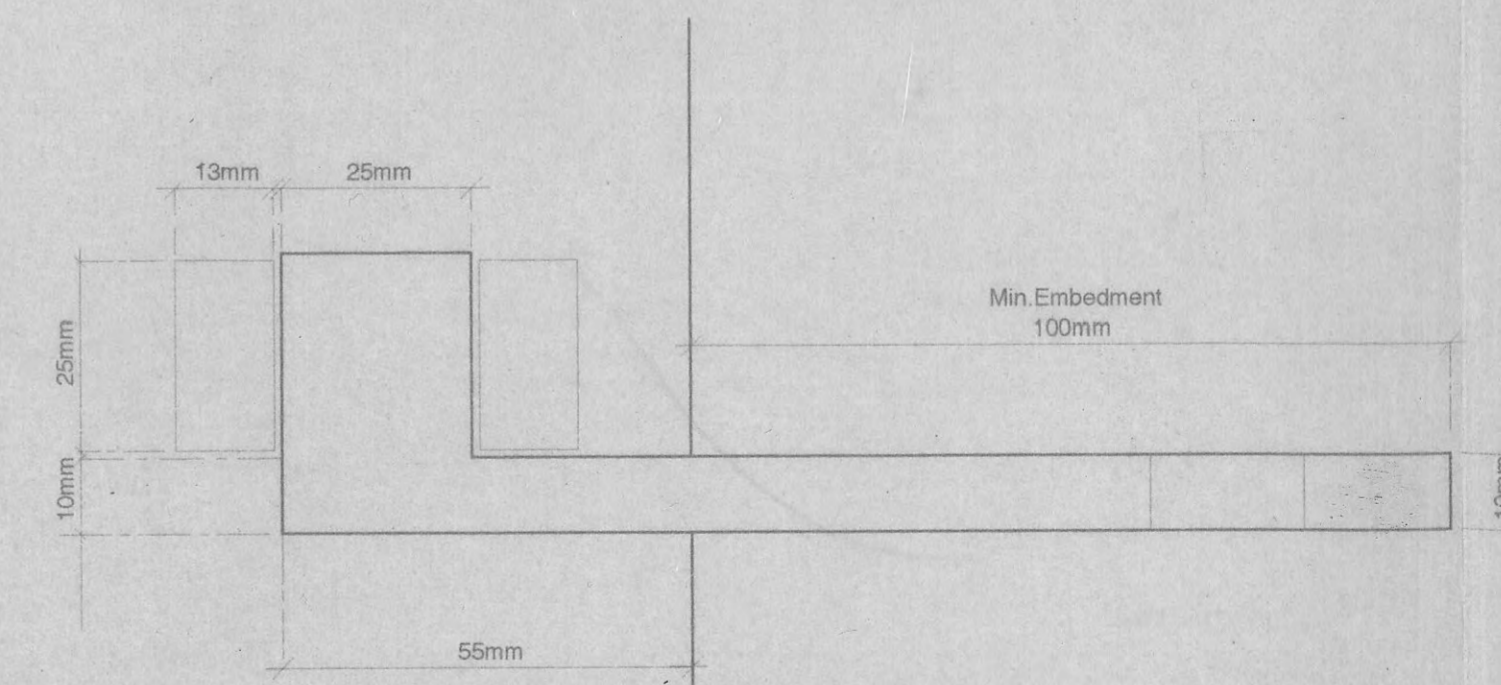

Section Through The Two Upper Hinges

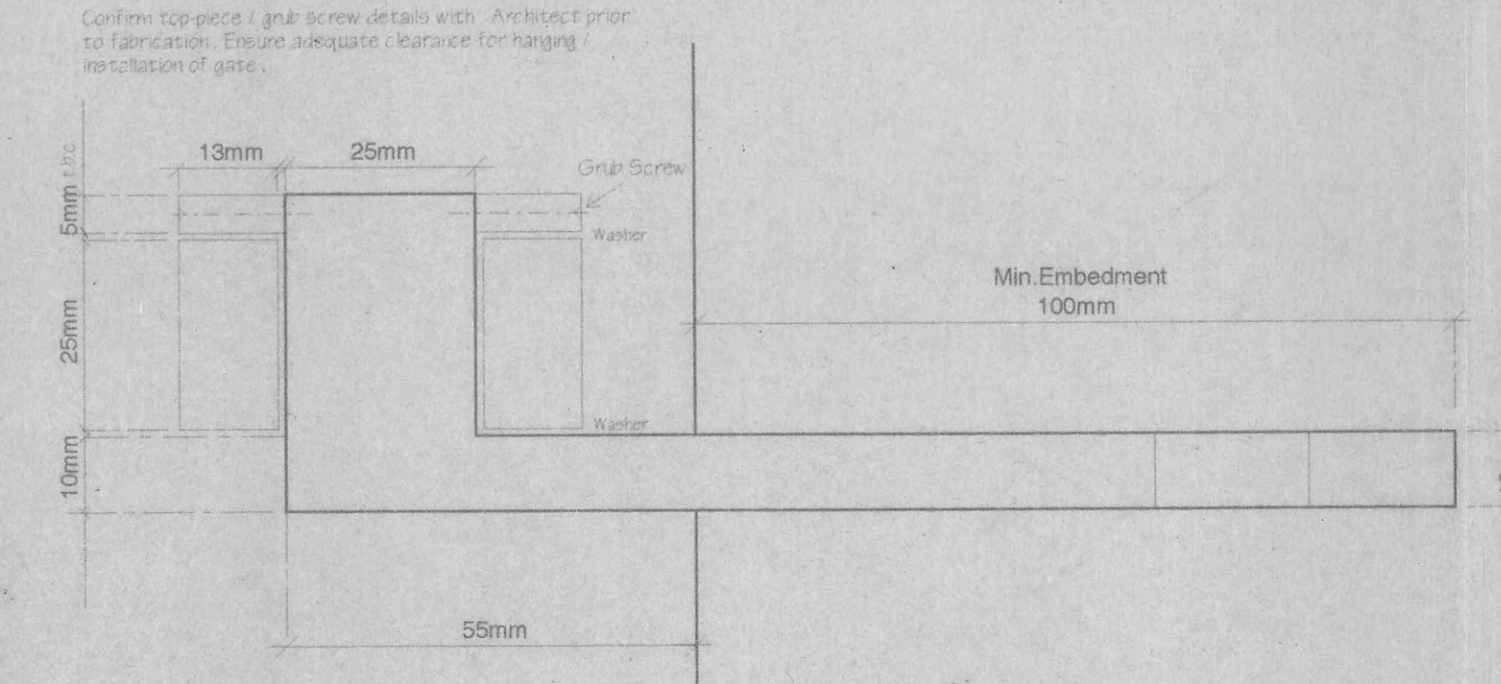

Section Through Lowermost Hinge

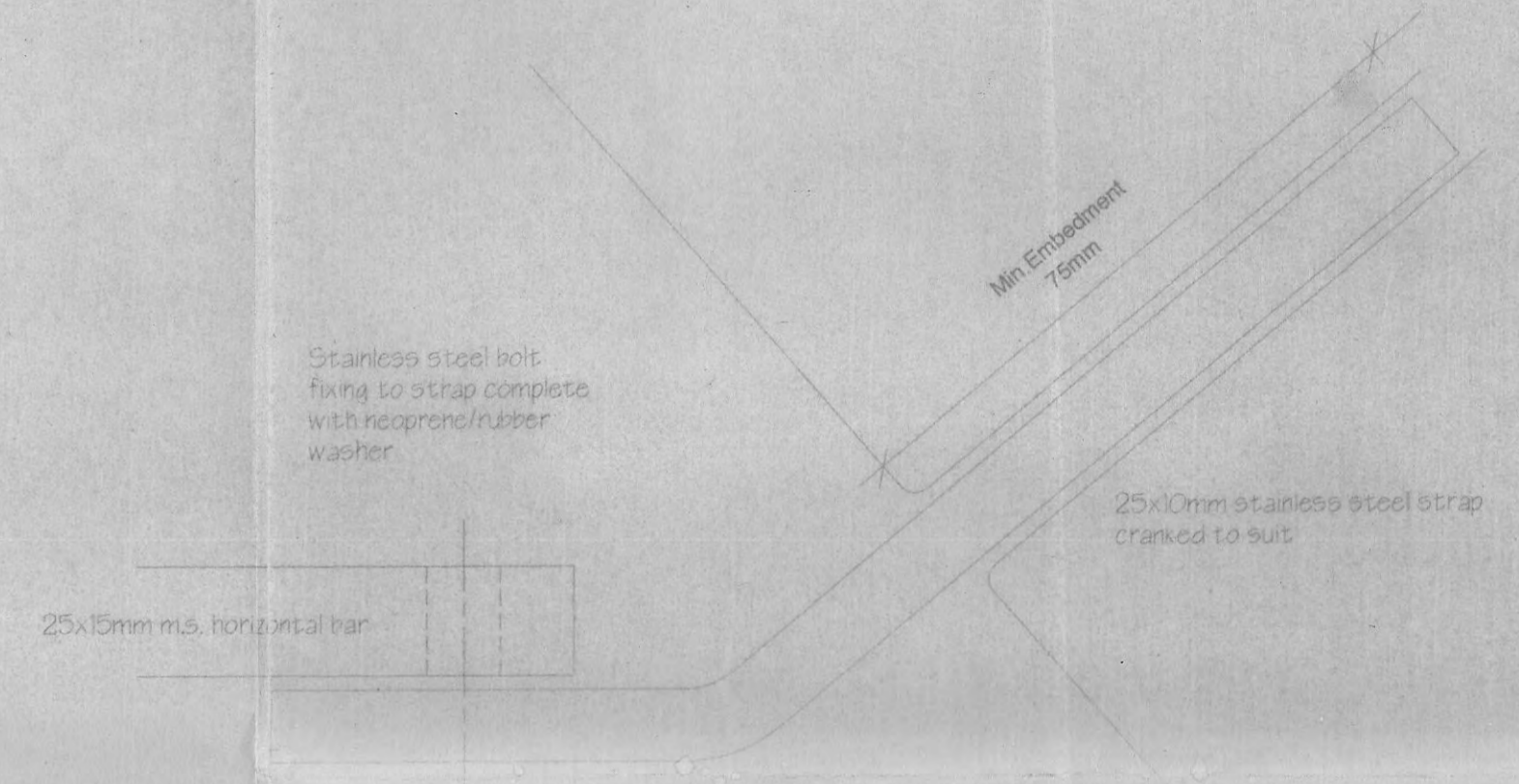

Detail F-F CRANKED STRAP

Carefully rake out joints by hand, ensuring enough space for cranks and taking care not to damage masonry. Insert custom made non-ferrous fixings as indicated, ensuring firm fixing. Point up full depth in layers max 25mm using 1:3 St. Astier moderately hydraulic lime : s and mix. Straps to be positioned to suit mortar joints and horizontal bar positions.

NOTES :

1. Do not scale from this drawing
2. All dimensions to be templated and checked on site prior to fabrication and any discrepancies to be reported to the architect immediately.
3. The site is a scheduled ancient monument. Under no circumstances will cutting up of masonry, excavations or other ground disturbance, use of power tools, mixing of mortar on the solum, or other damaging operations be permitted.
4. Masonry is in poor condition. Ensure that all operatives wear PPE including hard hats. Monitor masonry regularly for evidence of movement during works.
5. Materials:
Yett: Galvanised mild steel or wrought iron.
Hinges and Holdfast: Stainless steel or phosphor bronze.

B Hinge Detail changed JMF 25/8/98
A Cranked strap added pd 4/8/98

REVISIONS

JOB	Castle Tioran, Moidart		
	Inverness-shire		
DRAWING	Proposed Yett		
	Construction Details		
SCALE	1:1, 1:20	DRAWN	J.M.F./P.D.
		DATE	7/98
DRAWING NO	5439 / 03	REV	B
CLIENT	Ania Estates Ltd		