

NOTES:
Do not scale from these drawings
Drawing to be read alongside structural engineer's drawings.

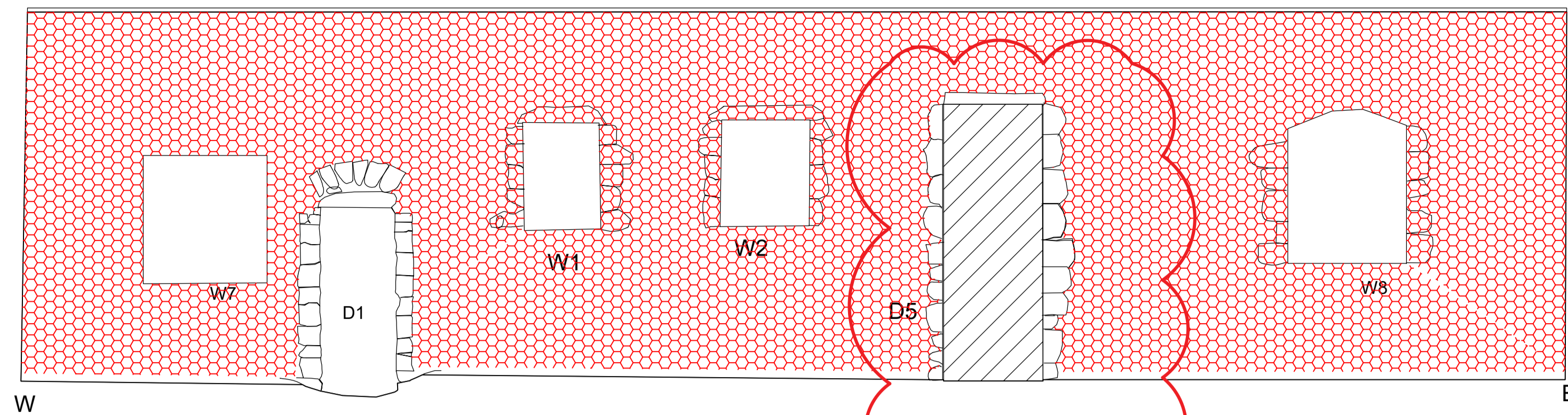
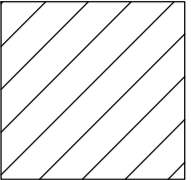
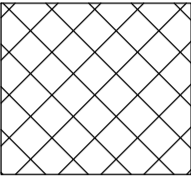
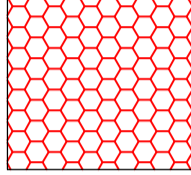

Proposed South Elevation
1:50

Open up windows as shown on plan.

-  Flush pointed stone with no finish
-  Blocked with cement render (on block)
-  Removal of 3-coat cementitious render make good masonry, and re-harl as specified.

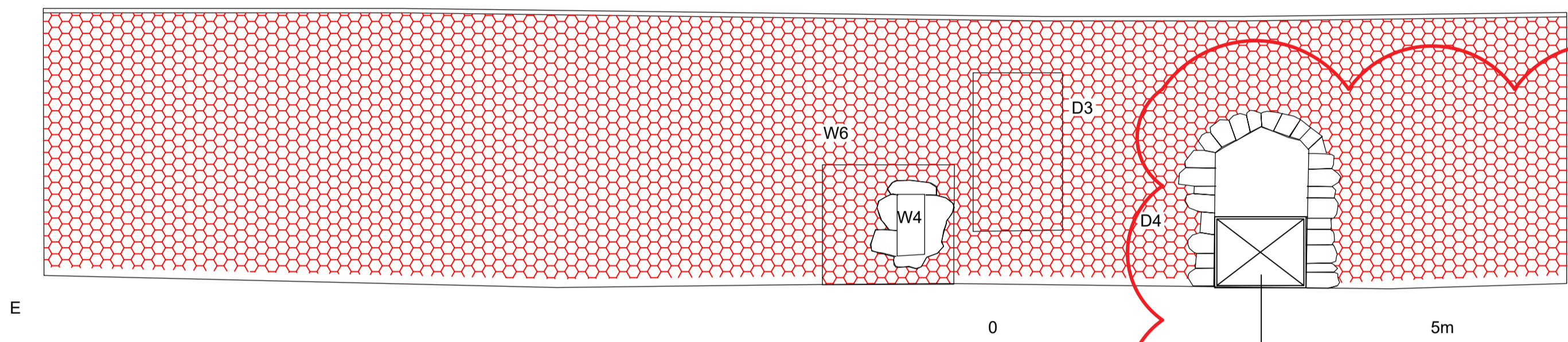
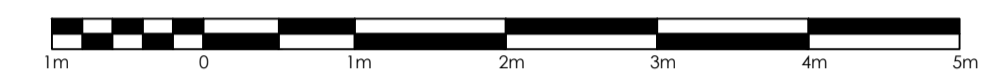

Proposed North Elevation
1:50

Open up doorway by removing stone infill. Bespoke steel screen below 800mm high rail to act as guarding.

Methodology

Generally: Following inspection of sample area and confirmation of bedding, pointing, and harling specifications, continue with careful removal of existing 3-coat cementitious render.

The expert use of oscillating mechanical power tools to assist may only be considered in strictly controlled conditions and following approval by the Architect which may not be given. No angle grinders or rotary tools are acceptable.

Pinning stones and lime mortar: if stabilisation of wall integrity is a concern, or if pinning stones fall loose, carefully retain to reinstate in their original location. Rake out areas that have fallen loose and flush any decayed mortar with water. Rake out to a minimum depth of 35mm and re-point to a flush finish.

Assume:
20% existing tec coat in tact, no re-pointing required.
20% pointing c. 35mm depth
60% pointing up to 100mm deep including re-building with new pinnings.
Hot mixed lime to be used, as per specification clause Z21r.

Allow for replacement red sandstone quoins where they are found to have lost face.

Harling: once fully prepared, proceed to harl the elevations as shown, as set out in Eala specification Z22r.

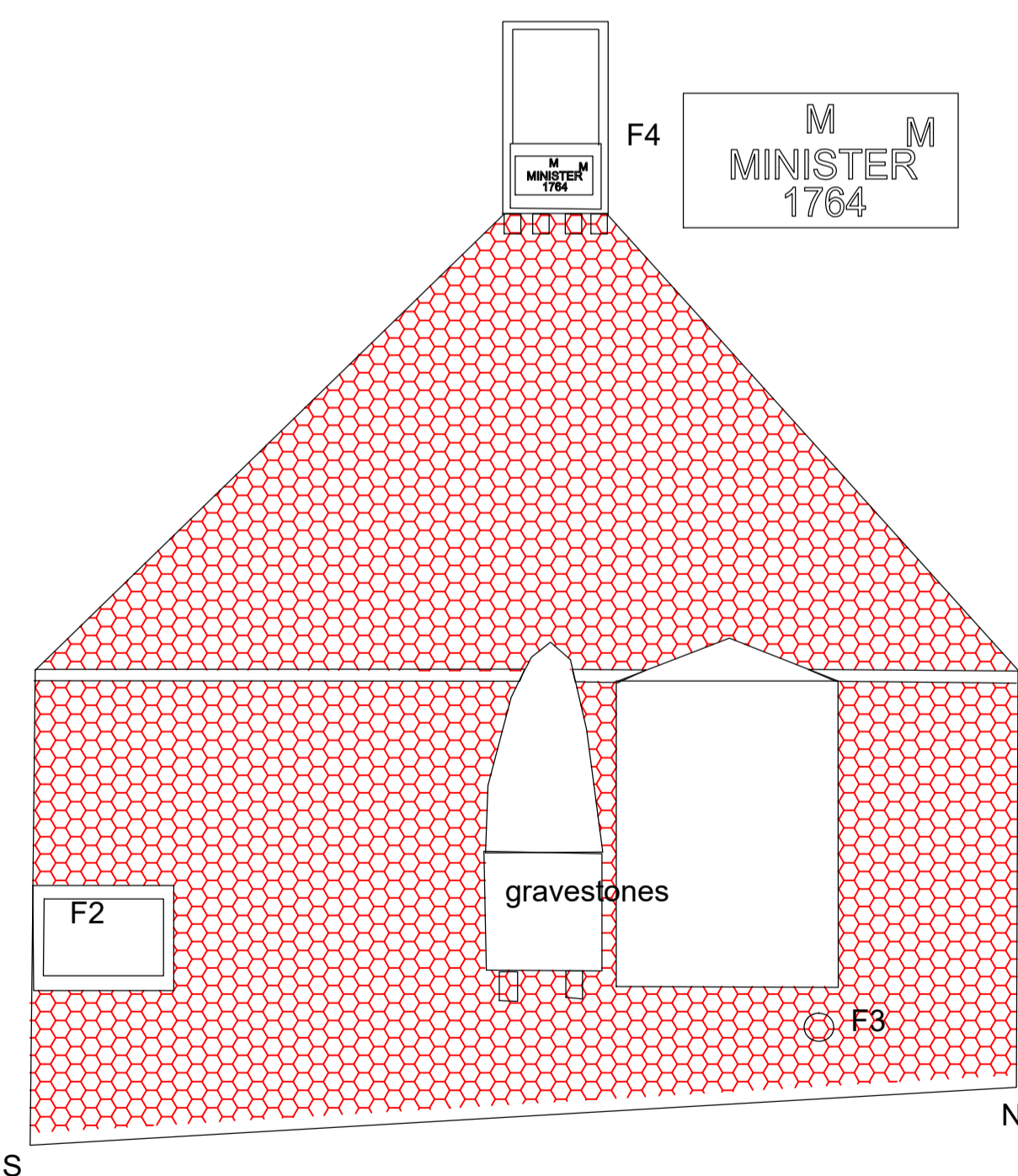

Existing East Elevation
1:50

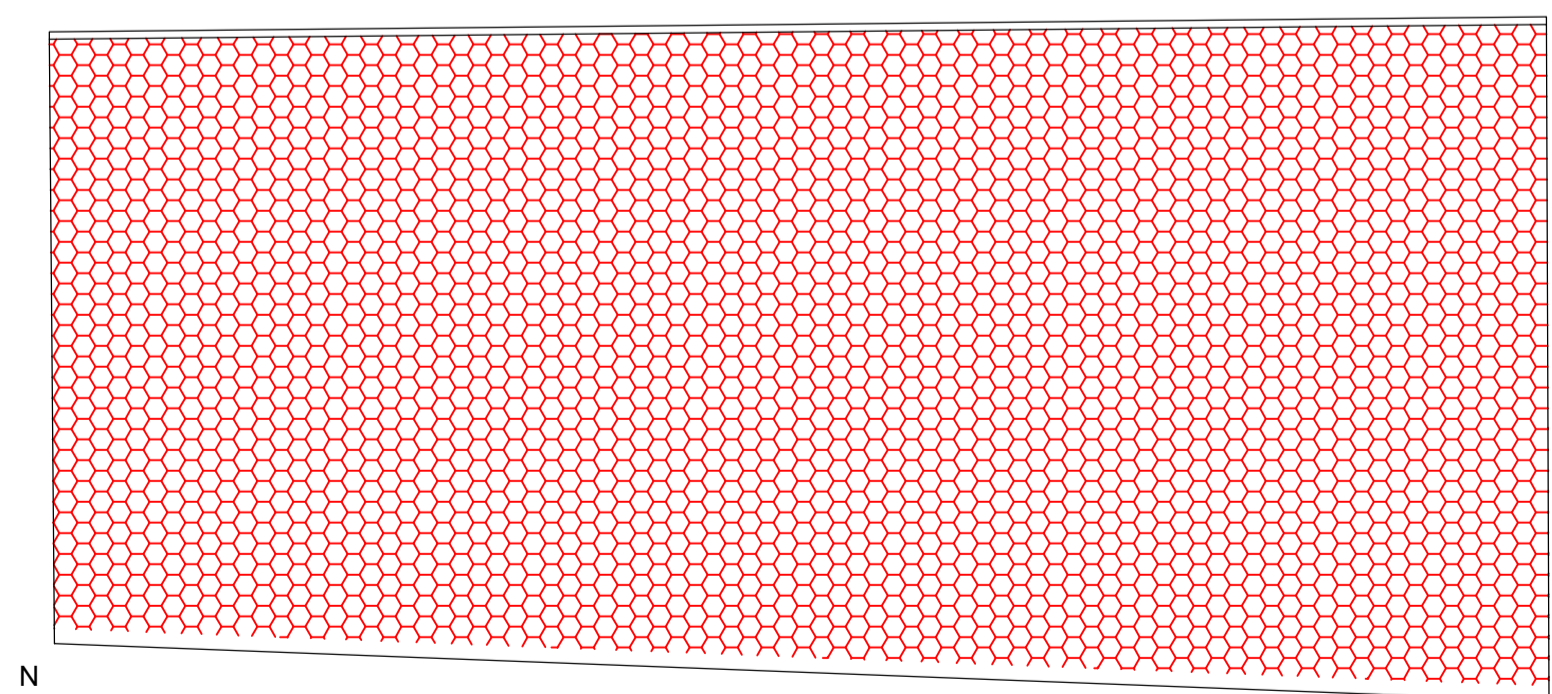

Existing West Elevation
1:50

Rev A - render extent and openings altered
- 03.09.2025

197
ETZ ST FITTICKS CHURCH
197-P-5-G-(2-)-004A
Phase 2
Proposed External Elevations
SITE

Scale: Date:
1:50 JULY 2025
A1