

Job Title:
 1566: Fabric Repairs
 The Cathedral Church of St Machar,
 ABERDEEN

Drawing Title:
 Scheduled Monument Consent
 Site Plan, Suggested Drainage Repairs

Drawing Status:
SCHEDULED MONUMENTS

Drawing Number:
 1566_L(SM)011

Scale: 1:200 @ A1 Date: September 2020 Drawn: GP

Revisions:

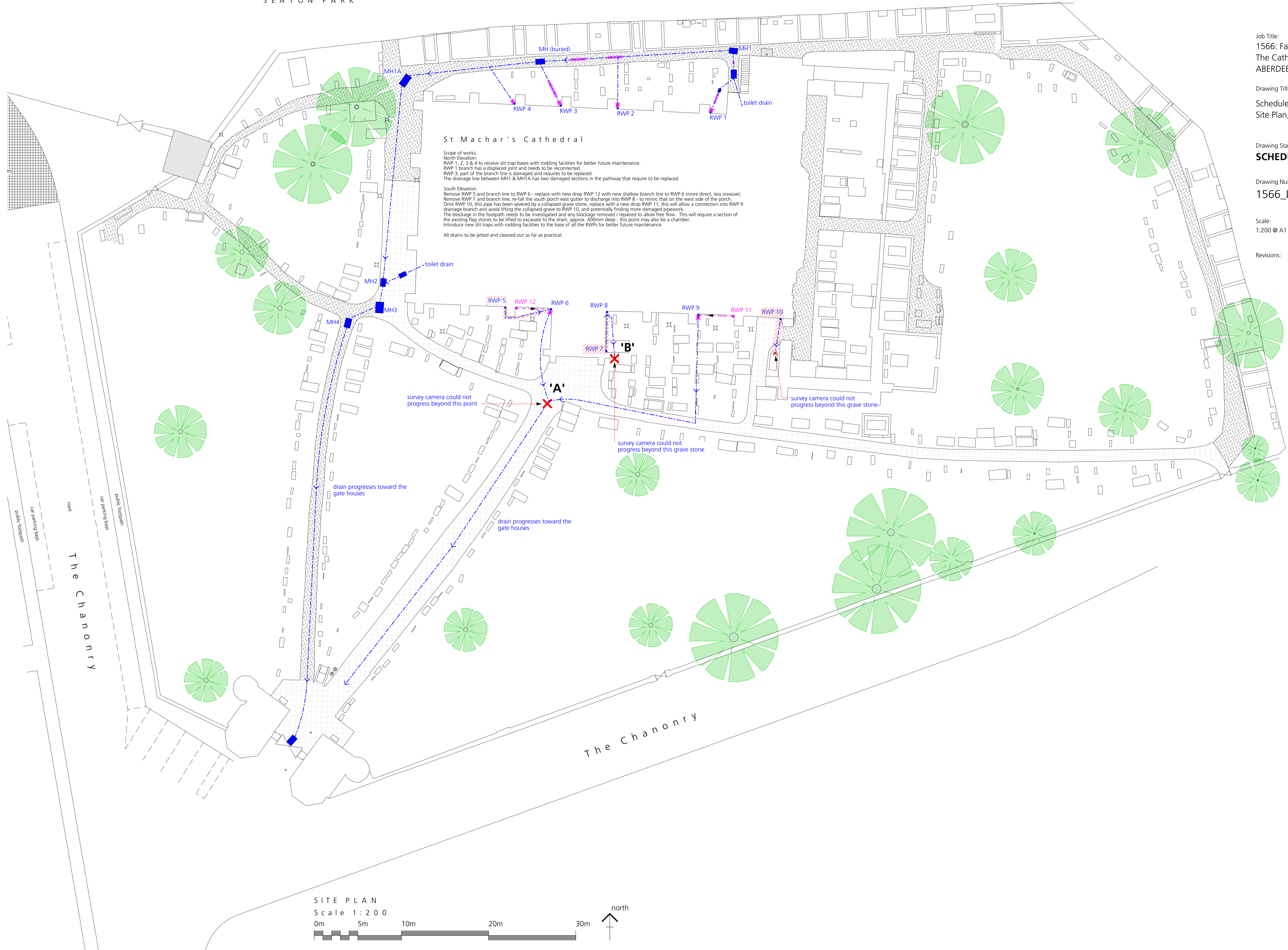

St Machar's Cathedral

Scope of works:
 North Elevation:
 RWP 1, 2, 3 & 4 to receive slit trap bases with rodding facilities for better future maintenance.
 RWP 1 branch has a displaced joint and needs to be reconnected.
 RWP 3, part of the branch line is damaged and requires to be replaced.
 The drainage line between MH1 & MH1A has two damaged sections in the pathway that require to be replaced.

South Elevation:
 Remove RWP 5 and branch line to RWP 6 - replace with new drop RWP 12 with new shallow branch line to RWP 6 (more direct, less invasive).
 Remove RWP 7 and branch line, re-fill the south porch east gutter to discharge into RWP 8 - to mimic that on the west side of the porch.
 Omit RWP 10, this pipe has been severed by a collapsed grave stone, replace with a new drop RWP 11, this will allow a connection into RWP 9
 drainage branch and avoid lifting the collapsed grave to RWP 10, and potentially finding more damaged pipework.
 The blockage in the footpath needs to be investigated and any blockage removed / repaired to allow free flow. This will require a section of
 the existing flag stones to be lifted to excavate to the drain, approx. 400mm deep - this point may also be a chamber.
 Introduce new slit traps with rodding facilities to the base of all the RWPs for better future maintenance.
 All drains to be jetted and cleaned out as far as practical.

