

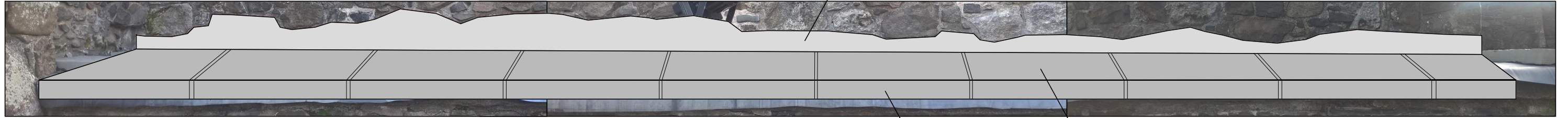

View of Existing (Showing temporary covering)

Lead flashing dressed into existing joints
(Indicative only - Final location to be confirmed by District Architect in discussion with lead contractor)



View of Proposed

Front edge turned down to form drip

New lead capping over projection

Lead flashing to be dressed into existing rubble joint (joint will undulate to suit existing coursing) & fixed at approx 450 centres with stainless steel screws and washers into plastic wall plugs. Pointed with polysulphide mastic coloured to match lead

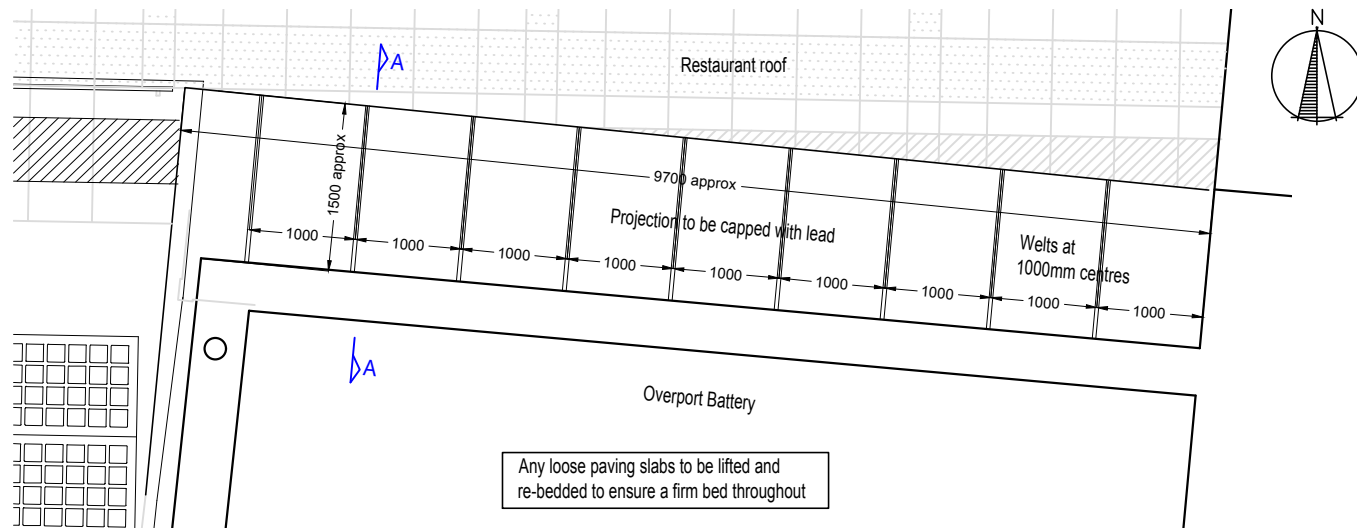

Plan 1:50

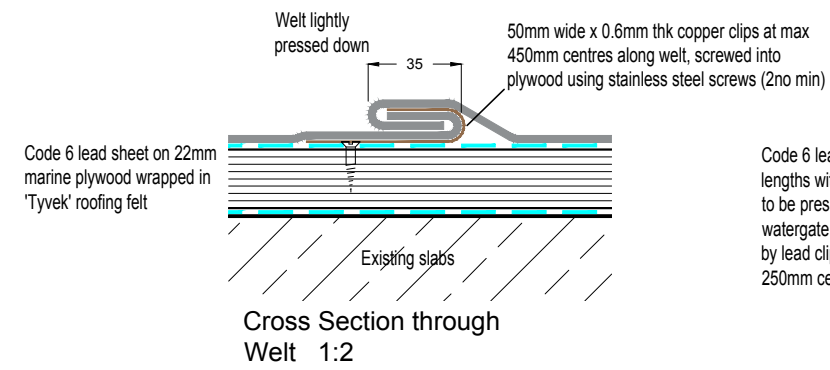

Cross Section through Welt 1:2

Code 6 lead cover flashing fixed in max 1500mm lengths with 150mm laps between lengths. Lead to be pressed min 150mm over upstand of watergate. Lower edge to be secured in position by lead clips welded to flashing at maximum 250mm centres and at laps

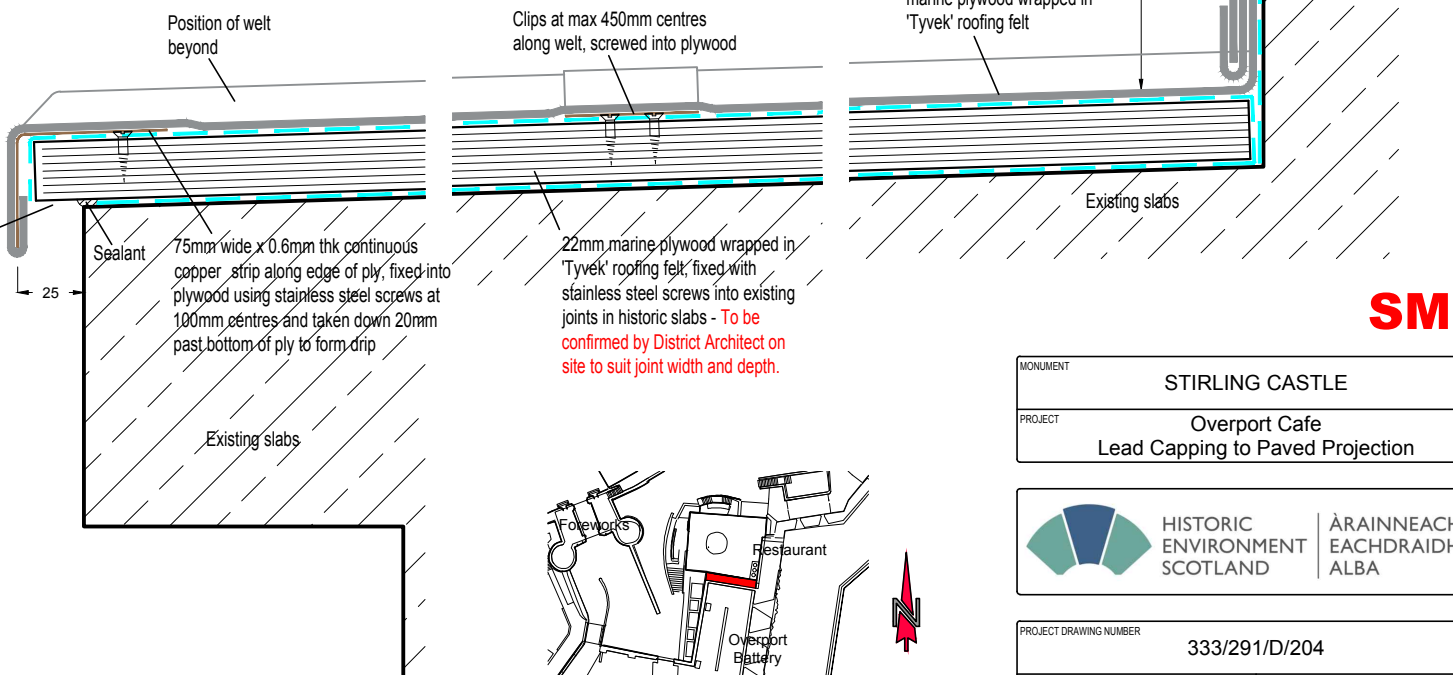

Vertical Section Section A-A through Projection 1:2

— Denotes Tyvek roofing felt

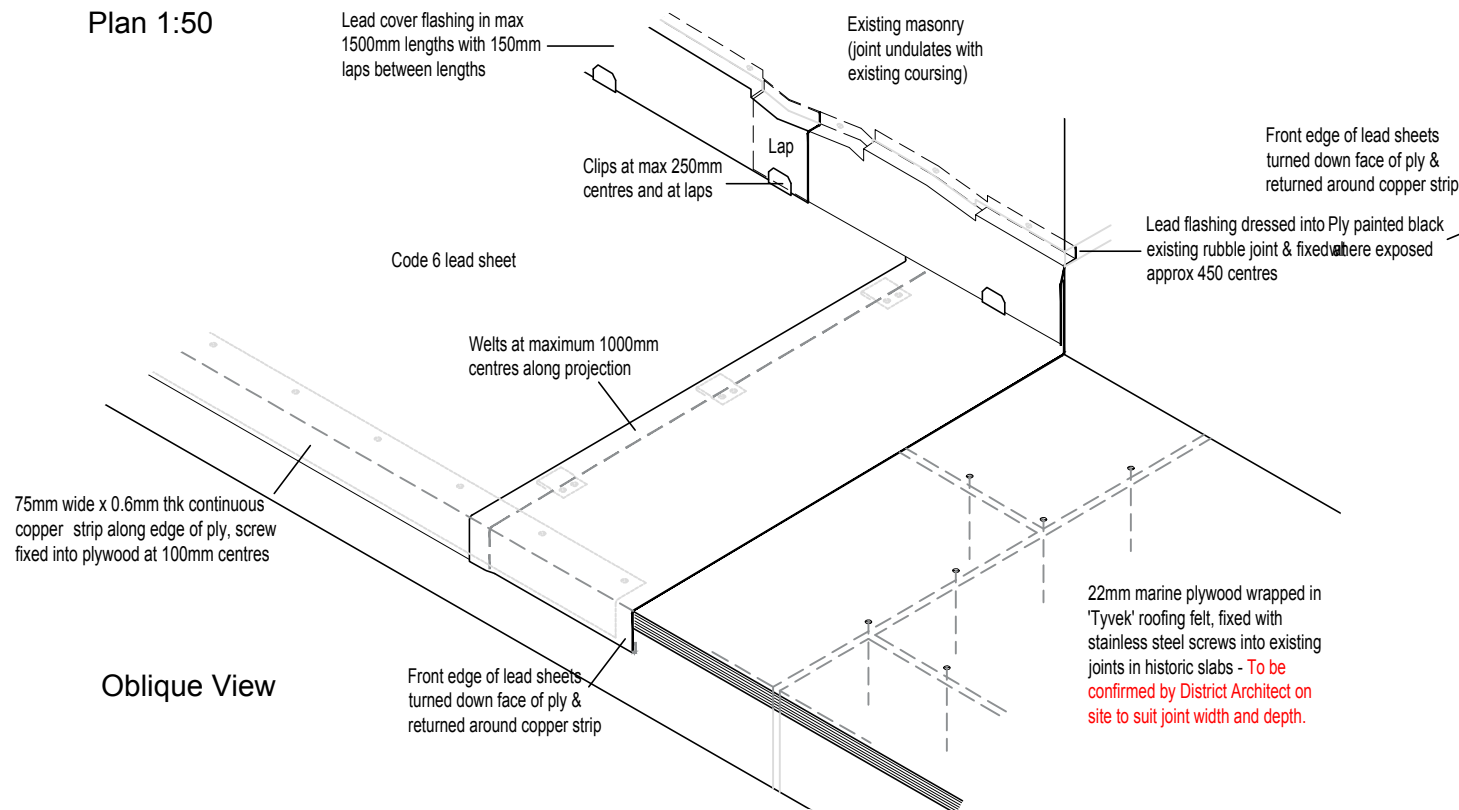

Oblique View

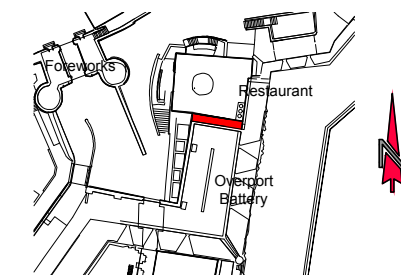

Location plan

SMC

MONUMENT	STIRLING CASTLE
PROJECT	Overport Cafe Lead Capping to Paved Projection

	HISTORIC ENVIRONMENT SCOTLAND	ÀRAINNEACHD EACHDRAIDHEIL ALBA
--	-------------------------------	--------------------------------

PROJECT DRAWING NUMBER	333/291/D/204
SCALE	1:50, 1:10, 1:2 @A2
ARCHITECT	T Gaze
DATE	September 2016
DRAWN BY	IDC
ARCHIVE NUMBER	