

THE ANCIENT MONUMENTS AND ARCHAEOLOGICAL AREAS ACT 1979 12435
ENTRY IN THE SCHEDULE OF MONUMENTS

The monument known as Valleyview, cairn 90m ENE of comprises the remains of a cairn of neolithic or Bronze-Age date. It survives as a stony mound near the summit of an unnamed hill, at 70m above sea level. The monument measures 19m in diameter and 1.35m in height. The area to be scheduled is square on plan, to include the remains described and an area around within which evidence relating to their construction and use may survive. The above-ground elements of the electricity pylon on the south-east are specifically excluded from the scheduling, to allow for its maintenance; the scheduling extends up to but excludes the post-and-wire fences on the west and north. The monument, which lies in the Parish of Fintray and the County of Aberdeen as shown in red on the Plan annexed and executed as relative hereto [REDACTED]

[REDACTED] is hereby included in the Schedule of Monuments appearing to the Scottish Ministers to be of national importance compiled and maintained by them under section 1(1) of the Ancient Monuments and Archaeological Areas Act 1979.

Subscribed by Malcolm Cooper, Chief Inspector with Historic Scotland, being an officer of the Scottish Ministers at Edinburgh on the 20 day of Feb Two thousand and nine, before this witness Luke Wormald, of Longmore House, Salisbury Place, Edinburgh.

[REDACTED] Witness

[REDACTED] Chief Inspector

REGISTERS OF SCOTLAND
GENERAL REGISTER OF SASINES
COUNTY OF ABERDEEN
YEAR 2009 1121
YEARLY RUNNING NUMBER
PRESENTED AND RECORDED ON 24 MAR 2009

This is the plan referred to in the entry in the Schedule affecting:
Valleyview, cairn 90m ENE of

dated: 20/2/09 and is signed as relative thereto.

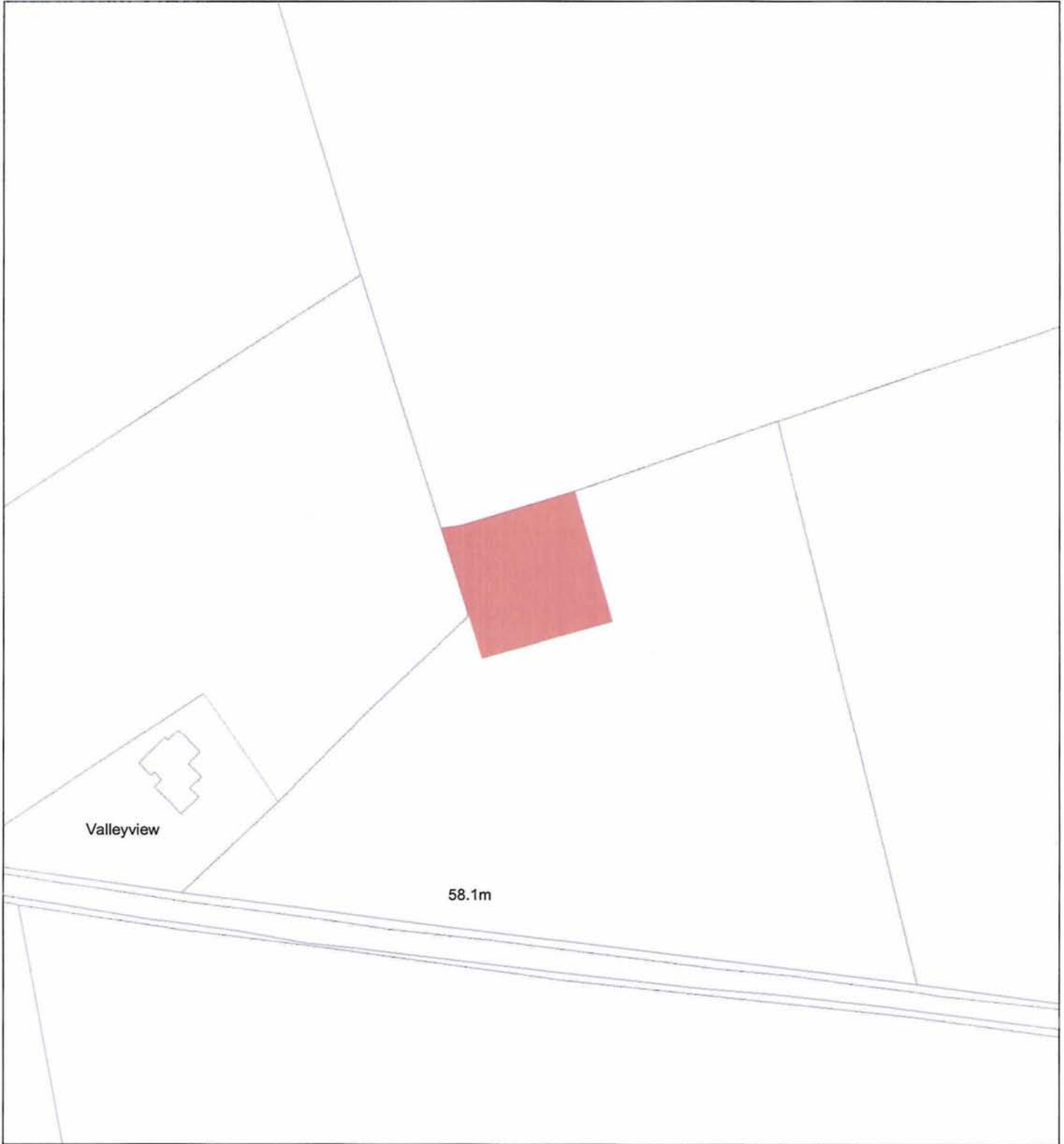

Index No: 12435
Valleyview, cairn 90m ENE of

Fintray Parish
Scheduled Area



N

Mapsheet(s):
NJ81NW

Scale: 1:1,250
0 10 20 30 40 50
 Metres

This map is reproduced from Ordnance Survey material with the permission of Ordnance Survey on behalf of the Controller of Her Majesty's Stationery Office © Crown copyright. Unauthorised reproduction infringes Crown copyright and may lead to prosecution or civil proceedings. Historic Scotland Licence No. 100017509 [2008].

YEARLY RUNNING
NUMBER
24 MAR 2009

ABN

7

THE ANCIENT MONUMENTS AND
ARCHAEOLOGICAL AREAS ACT 1979

Entry in the Schedule of Monuments

2009

Re: The Monument known as
Valleyview, cairn 90m ENE of

in the Parish of Fintray and
County of Aberdeen

Search Sheet No: 14322

500180150503

Historic Scotland
Longmore House
Salisbury Place
Edinburgh