

THE ANCIENT MONUMENTS AND ARCHAEOLOGICAL AREAS ACT 1979
ENTRY IN THE SCHEDULE OF MONUMENTS

12018

The monument known as Mithergarth, ring-ditch houses 280m SSE of comprises a group of four ring-ditch houses of prehistoric date. The ring-ditches are visible as upstanding features in a mature conifer plantation on a NE-facing terrace on the E flank of Bennachie. The houses are likely to date from the Late Bronze Age or Iron Age, the first or second millennium BC. The NW house measures 17m in diameter. Its walls are defined by a circular stony bank measuring up to 4m in thickness and 0.7m in internal height. A shallow ditch measuring 2.7m wide runs around the inside edge of the bank. Approximately 30m to the south lies the SW house in the group. It is oval in shape and measures 16m in diameter. The wall is defined by a circular stony bank measuring 3m in thickness and up to 1m in internal height. The NE house lies 40m to the ENE of the first. It is scooped into the hillside and measures 13m in diameter. The last house lies on the SE edge of the group, 50m to the south-east of the first. It measures 15m in diameter and is scooped into the hillside. The area to be scheduled is sub-rectangular, to include the remains described and an area around them within which evidence relating to their construction and use may survive. The monument, which lies in the Parish of Chapel of Garioch and the County of Aberdeen as shown outlined in red on the Plan annexed and executed as relative hereto

 is hereby included in the Schedule of Monuments appearing to the Scottish Ministers to be of national importance compiled and maintained by them under section 1(1) of the Ancient Monuments and Archaeological Areas Act 1979.

Subscribed by Malcolm Cooper, Chief Inspector with Historic Scotland, being an officer of the Scottish Ministers at Edinburgh on the 9 day of November Two thousand and seven, before this witness Victoria Ball, of Longmore House, Salisbury Place, Edinburgh.

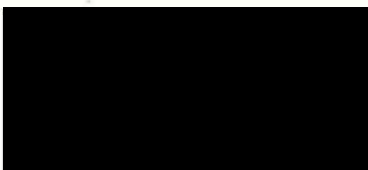
 Witness

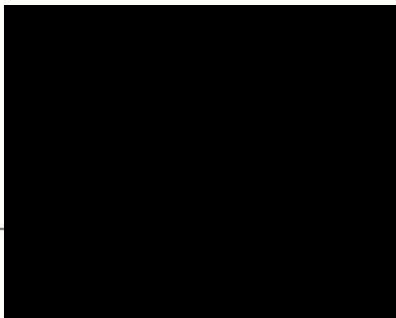
 Chief Inspector

LD00111.Sch

REGISTERS OF SCOTLAND
GENERAL REGISTER OF SASINES
COUNTY OF ABERDEEN
YEAR 2007
YEARLY RUNNING NUMBER
PRESENTED AND RECORDED ON

5226
28 DEC 2007

This is the plan referred to in the entry in the Schedule affecting: [REDACTED]
Mithergarth, ring-ditch houses 280m SSE of [REDACTED]

dated: 9/11/07 and is signed as relative thereto.

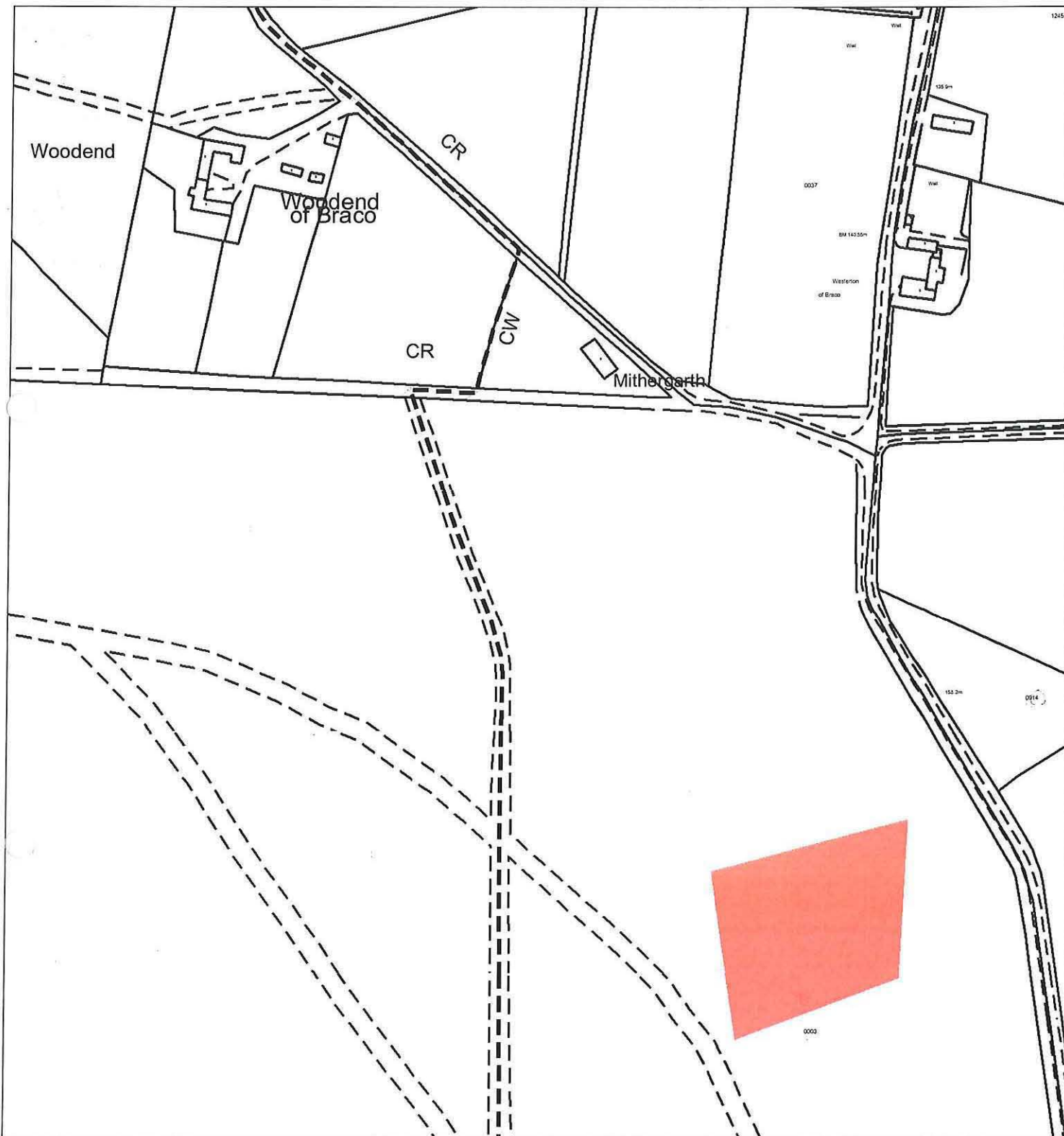

Index No: 12018

Mithergarth, ring-ditch houses
280m SSE of

Chapel of Garioch Parish

Scheduled Area 

N



Mapsheet(s):
NJ62SE
NJ72SW

Scale: 1:2,500

0 25 50 75 100 125 Metres

This map is reproduced from Ordnance Survey material with the permission of Ordnance Survey on behalf of the Controller of Her Majesty's Stationery Office © Crown copyright. Unauthorised reproduction infringes Crown copyright and may lead to prosecution or civil proceedings. Historic Scotland Licence No. 100017509 [2007].

ABN

25 DEC 2007
YEARLY RUNNING NO.

THE ANCIENT MONUMENTS AND
ARCHAEOLOGICAL AREAS ACT 1979

Entry in the Schedule of Monuments

13 14

2007

Re: The Monument known as
Mithergarth, ring-ditch houses 280m SSE of
in the Parish of Chapel of Garioch and
County of Aberdeen

SE0123366308

Search Sheet No: 14735

~~SE0123366301~~

Historic Scotland
Longmore House
Salisbury Place
Edinburgh