

12 MAR 2004  
YEABLY RUNNING NO  
326

6 Bn-f

THE ANCIENT MONUMENTS AND  
ARCHAEOLOGICAL AREAS ACT 1979

Entry in the Schedule of Monuments

2004 S40506681101

Re: The Monument known as  
Scotsmill, enclosure 150m WNW of

in the Parish of Fordyce and  
County of Banff

Search Sheet No: 6

Historic Scotland  
Longmore House  
Salisbury Place  
Edinburgh

THE ANCIENT MONUMENTS AND ARCHAEOLOGICAL AREAS ACT 1979  
ENTRY IN THE SCHEDULE OF MONUMENTS

11112

The monument known as Scotsmill, enclosure 150m WNW of, comprises the ploughed-down remains of a ditched enclosure, within which are the remains of a building, visible as a cropmark on aerial photographs, situated in a gently-sloping field. The area to be scheduled is a circle 45m in diameter, centred on the enclosure, to include the enclosure and an area around in which features associated with its construction and use are likely to survive. The monument, which lies in the Parish of Fordyce and the County of Banff as shown outlined in red on the Plan annexed and executed as relative hereto and which forms

[REDACTED] hereby included in the Schedule of Monuments appearing to the Scottish Ministers to be of national importance compiled and maintained by them under section 1(1) of the Ancient Monuments and Archaeological Areas Act 1979.

Subscribed by Sheenagh Adams, Director of Heritage Policy with Historic Scotland, being an officer of the Scottish Ministers at Edinburgh on the 9<sup>th</sup> day of February Two thousand and four, before this witness Lesley Macdonald, of Longmore House, Salisbury Place, Edinburgh.

[REDACTED] Director of Heritage Policy

Register on behalf of the Scottish Ministers in the Register of the County of Banff.

[REDACTED]  
An Officer of the Scottish Ministers

MFA05593.014

REGISTERS OF SCOTLAND  
GENERAL REGISTER OF SASINES  
COUNTY OF BANFF  
FICHE 29 FRAME 14  
PRESENTED AND RECORDED ON

12 MAR 2004

BNF 0 4 . . . . 2 9

14

This is the plan referred to in the entry in the Schedule affecting Scotsmill, enclosure 150m WNW of, dated: 9/2/04 and is signed as relative thereto.

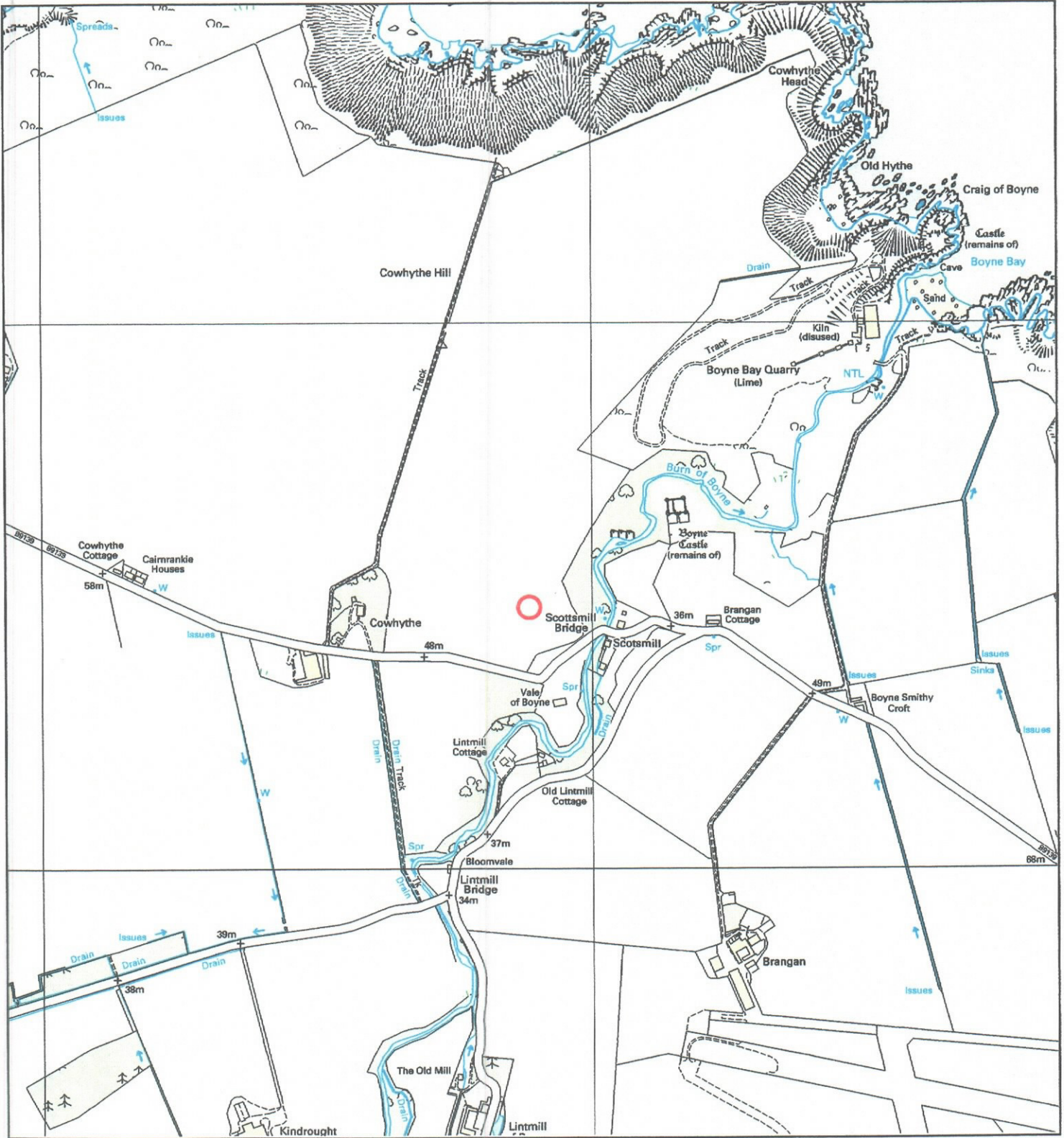

Scotsmill, enclosure 150m WNW of

Fordyce Parish



Scheduled Area



MapSheet: NJ66NW

Scale 1:10,000



This map is reproduced from the OS map by Historic Scotland with the permission of The Controller of Her Majesty's Stationery Office, © Crown copyright. Unauthorised reproduction infringes Crown Copyright and may lead to prosecution or civil proceedings. Licence No. GD 03135G0014.