

THE ANCIENT MONUMENTS AND
ARCHAEOLOGICAL AREAS ACT 1979

BNF

18 FEB 2004
YEARLY RUNNING No. - 206

Entry in the Schedule of Monuments

?

(5)

2004

Re: The Monument known as
Law of Balgreen, cairn

in the Parish of Gamrie and
County of Banff

Search Sheet No: 183

SA 050 28 38601

Historic Scotland
Longmore House
Salisbury Place
Edinburgh

THE ANCIENT MONUMENTS AND ARCHAEOLOGICAL AREAS ACT 1979
ENTRY IN THE SCHEDULE OF MONUMENTS

The monument known as Law of Balgreen, cairn, comprises the remains of a prehistoric burial cairn, visible as an upstanding earthen mound. Cairns such as this are funerary and ritual monuments built during the Early Bronze Age (c.2500-1500BC). The area to be scheduled comprises the remains described and an area around them within which material relating to the construction and use of the cairn may be expected to survive. It is circular with a diameter of 55m, minus a chord on the SE side. The elements of a former hen house lying within the scheduled area are specifically excluded from the scheduling. The monument, which lies in the Parish of Gamrie and the County of Banff as shown outlined in red on the Plan annexed and executed as relative hereto

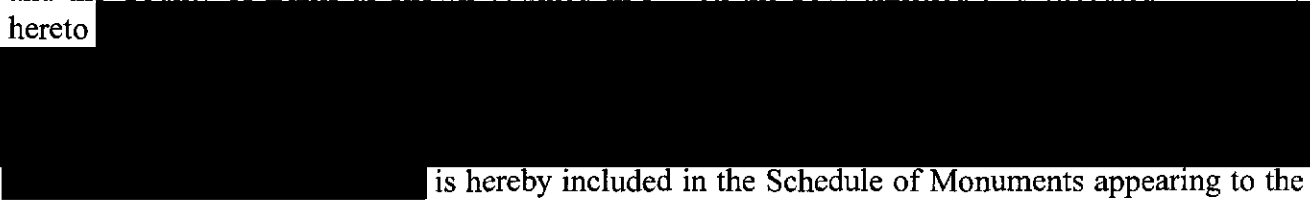

is hereby included in the Schedule of Monuments appearing to the Scottish Ministers to be of national importance compiled and maintained by them under section 1(1) of the Ancient Monuments and Archaeological Areas Act 1979.

Subscribed by Sheenagh Adams, Director of Heritage Policy with Historic Scotland, being an officer of the Scottish Ministers at Edinburgh on the 20th day of January Two thousand and four, before this witness Lesley Macdonald, of Longmore House, Salisbury Place, Edinburgh.

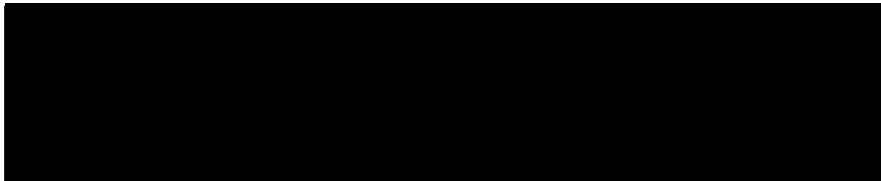

Director of Heritage Policy

Register on behalf of the Scottish Ministers in the Register of the County of Banff.

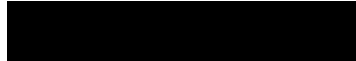

An Officer of the Scottish Ministers

MFA03593.123

REGISTERS OF SCOTLAND
GENERAL REGISTER OF SASINES
COUNTY OF BANFF
FICHE 17 FRAME 37
PRESENTED AND RECORDED ON

AM
18 FEB 2004



This is the plan referred to in the entry in the Schedule affecting Law of Balgreen, cairn, dated: 20/1/04 and is signed as relative thereto.

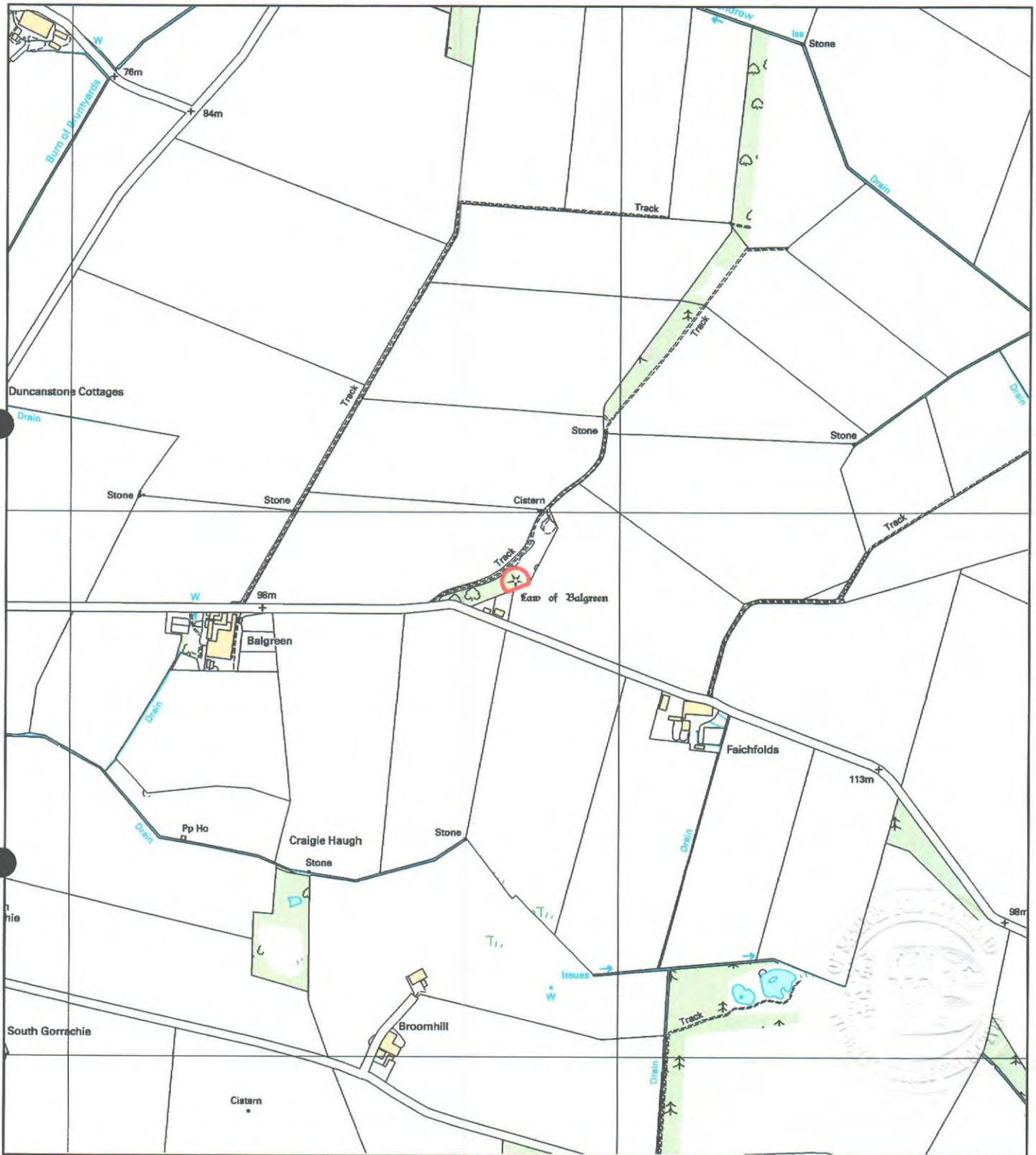

Law of Balgreen, cairn

Gamrie Parish



Scheduled Area



N



MapSheet: NJ75NW

Scale 1:10,000

100 0 100 200 300 400 500 Meters



This map is reproduced from the OS map by Historic Scotland with the permission of The Controller of Her Majesty's Stationery Office, © Crown copyright. Unauthorised reproduction infringes Crown Copyright and may lead to prosecution or civil proceedings. Licence No. GD 03135G0014.