

604

THE ANCIENT MONUMENTS AND
ARCHAEOLOGICAL AREAS ACT 1979

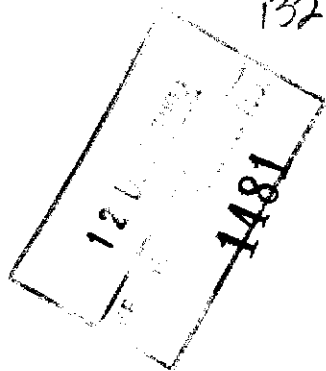

Entry in the Schedule of Monuments

1481

2002

Re: The Monument known as
St Fittick's Church

in the Parish of Aberdeen and
County of Kincardine

Search Sheet No: 132 (76 S of S)

621642921602

Historic Scotland
Longmore House
Salisbury Place
Edinburgh

THE ANCIENT MONUMENTS AND ARCHAEOLOGICAL AREAS ACT 1979
ENTRY IN THE SCHEDULE OF MONUMENTS

The monument known as St Fittick's Church comprises the remains of St Fittick's Church and its graveyard, visible as an upstanding monument. St Fittick's Church lies on open ground, adjacent to Balnagask golf course, overlooking Nigg Bay, at a height of about 10.5m OD. The area to be scheduled comprises the remains described and an area around them within which related material may be expected to survive. It is almost square in shape, with maximum dimensions of 36m NNW-SSE by 36.5m transversely. It is demarcated by the boundary wall of the graveyard. It excludes the annex to the NE containing twentieth-century graves. It also excludes the above-ground parts of the boundary wall to allow for routine maintenance. The monument, which lies in the Parish of Aberdeen and the County of Kincardine as shown outlined in red on the Plan annexed and

[REDACTED] is hereby included in the Schedule of Monuments appearing to the Scottish Ministers to be of national importance compiled and maintained by them under section 1(1) of the Ancient Monuments and Archaeological Areas Act 1979.

Subscribed by Sheenagh Adams, Director of Heritage Policy with Historic Scotland, being an officer of the Scottish Ministers at Edinburgh on the 30th day of October Two thousand and two, before this witness Lesley Macdonald, of Longmore House, Salisbury Place, Edinburgh.

[REDACTED] Director of Heritage Policy

Register on behalf of the Scottish Ministers in the Register of the County of Kincardine.

[REDACTED]
An Officer of the Scottish Ministers

KNC 0 2 . . . 1 1 5
MFA02190.082

REGISTERS OF SCOTLAND
GENERAL REGISTER OF SASINES
COUNTY OF KINCARDINE
FICHE 115 FRAME 9
PRESENTED AND RECORDED ON

12 DEC 2002

9

This is the plan referred to in the entry in the Schedule affecting St Fittick's Church, , dated: 30/10/02 and is signed as relative thereto.

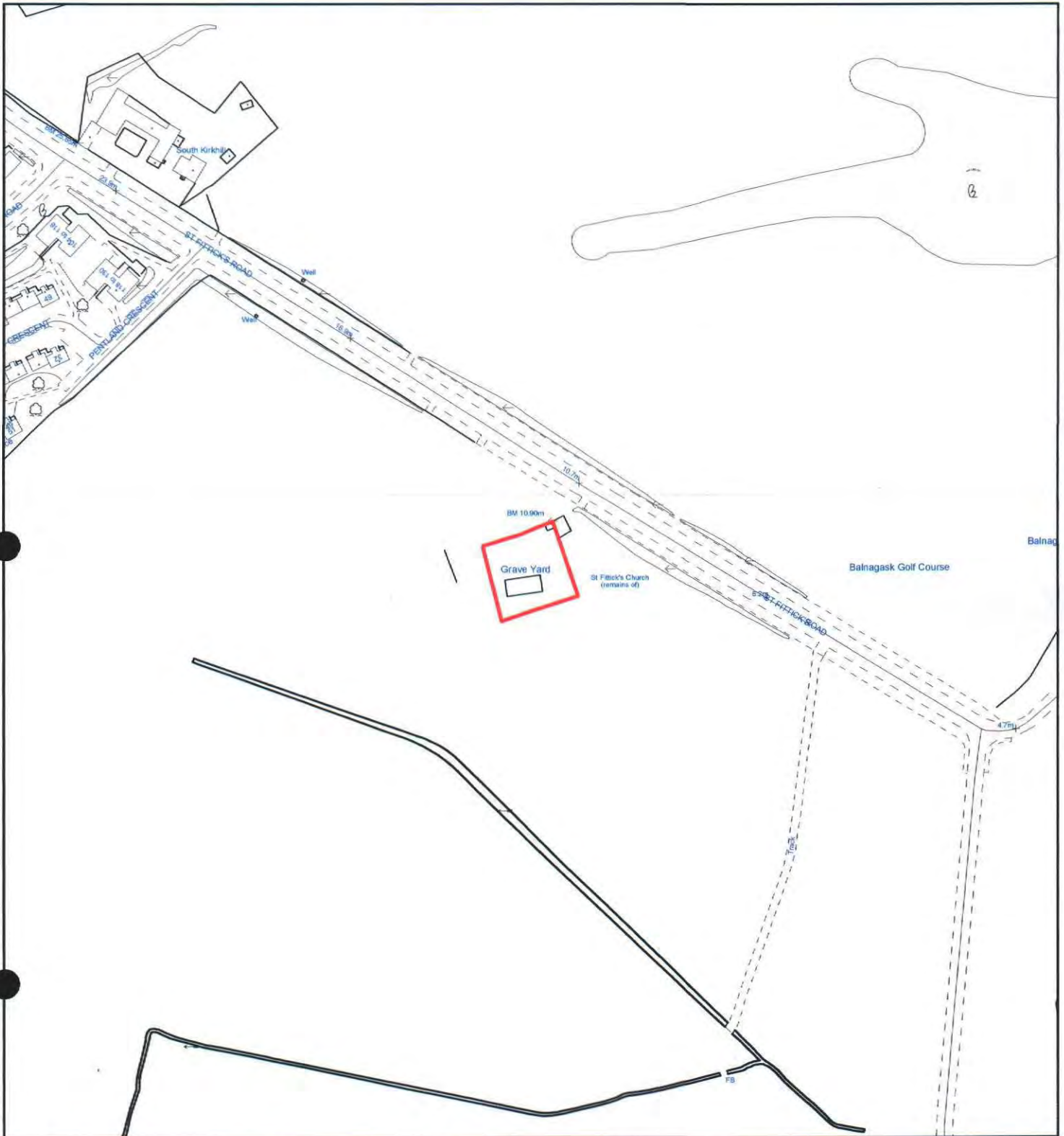

St Fittick's Church,
Aberdeen Parish

Scheduled Area —————



MapSheet: NJ90SE

Scale 1:2,500

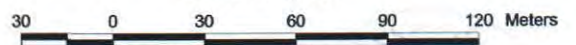

This map is reproduced from the OS map by Historic Scotland with the permission of The Controller of Her Majesty's Stationery Office, © Crown copyright. Unauthorised reproduction infringes Crown Copyright and may lead to prosecution or civil proceedings. Licence No. GD 03135G0014.

KNC 0 2 . . . 1 1 5

10