

PRELIMINARY

1442_L(SK)112

Spaces

- 1 Flat roof over lift entrance
- 2 Trapezoidal roof over classroom + fitness suite
- 3 Flat roof over main Sports Hall
- 4 Flat roof over Studio Hall
- 5 Existing Swimming Pool roof

Notes

- Red dashed line denotes line of previous proposal to illustrate extent of reduced area

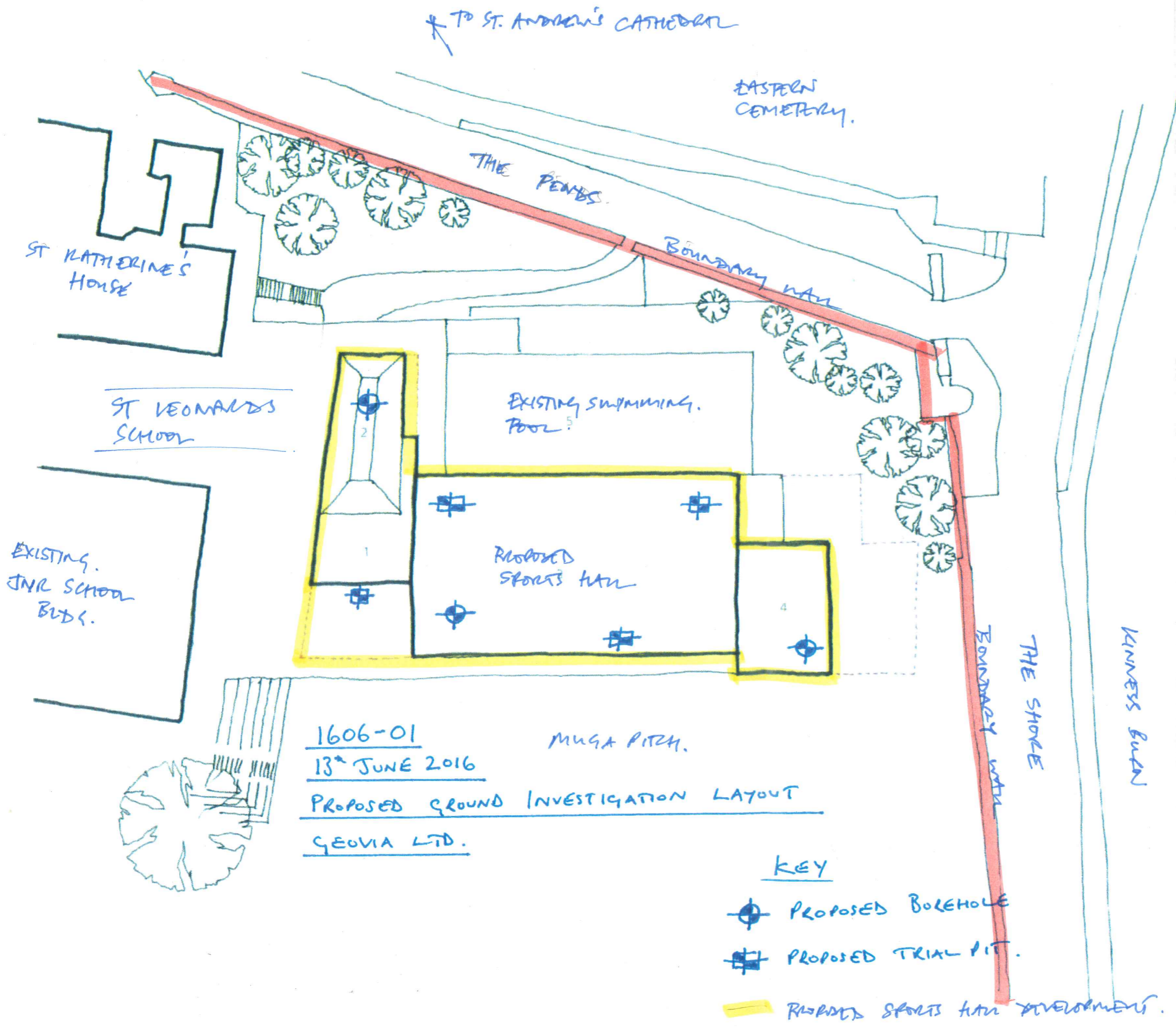

1606-01
 13th JUNE 2016
 PROPOSED GROUND INVESTIGATION LAYOUT
 GEOVIA LTD.

KEY

- PROPOSED BOREHOLE
- PROPOSED TRIAL PIT.
- PROPOSED SPORTS HALL DEVELOPMENT.

LOCATION PLAN

