

Fitting instructions for wall mounted signs

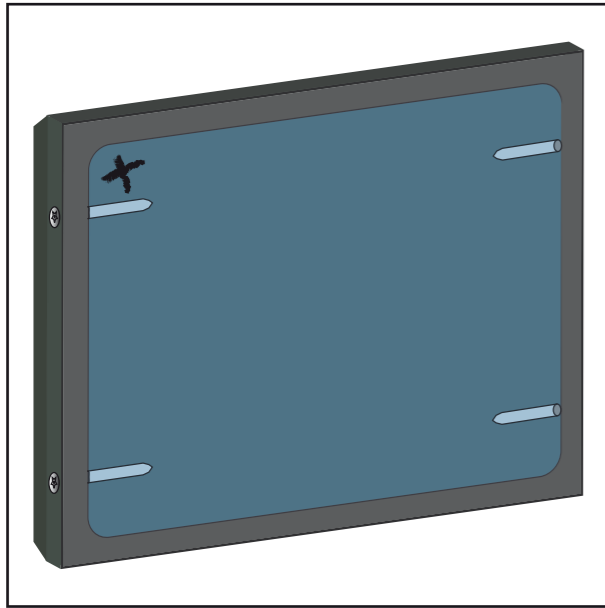

Mark the acrylic back in one corner - to ensure that you keep the acrylic the right way round and get a tight fit at the end of installation.

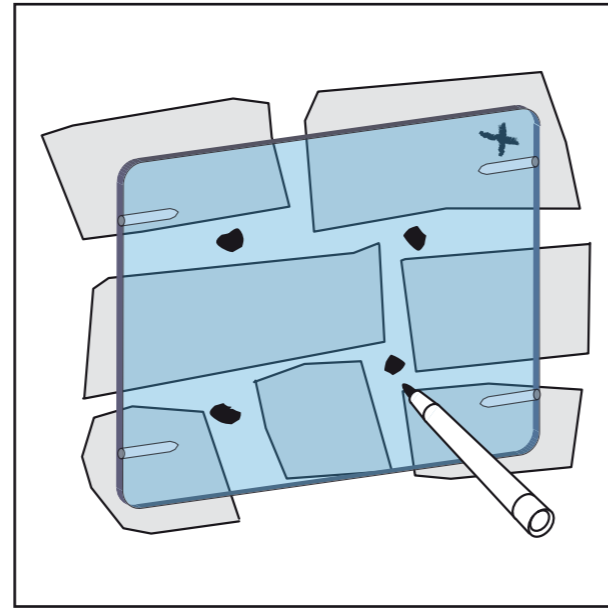

Undo the security screws and take the acrylic out. Hold it to the wall and mark the location of the mortar joints.

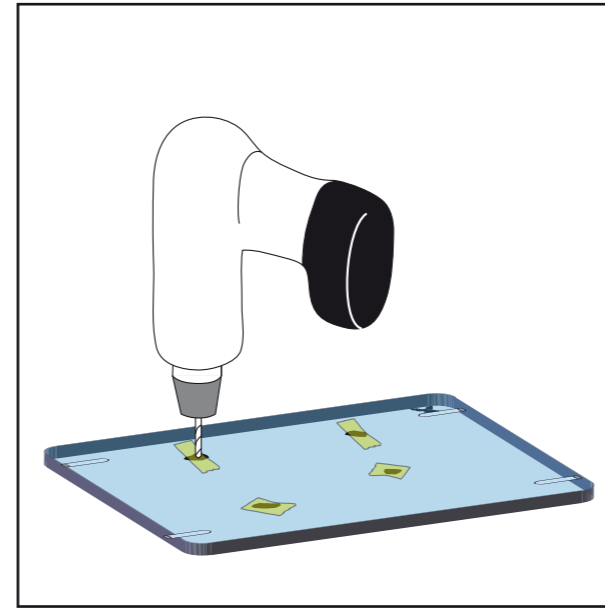

Put sellotape over the marks, which helps stop splinters. Drill holes suitable for countersunk fixings so the sign will fit flush over the plate.

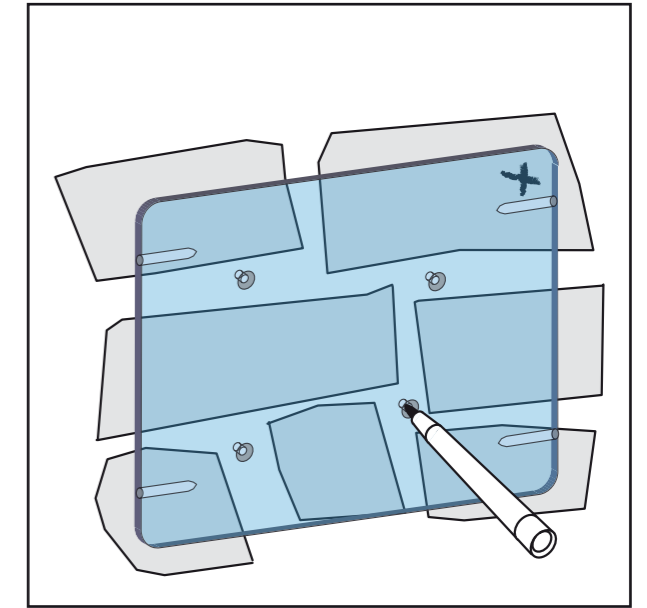

Hold the acrylic back to the wall and mark the spots to drill in the mortar or drill pilot holes through the holes in the acrylic.

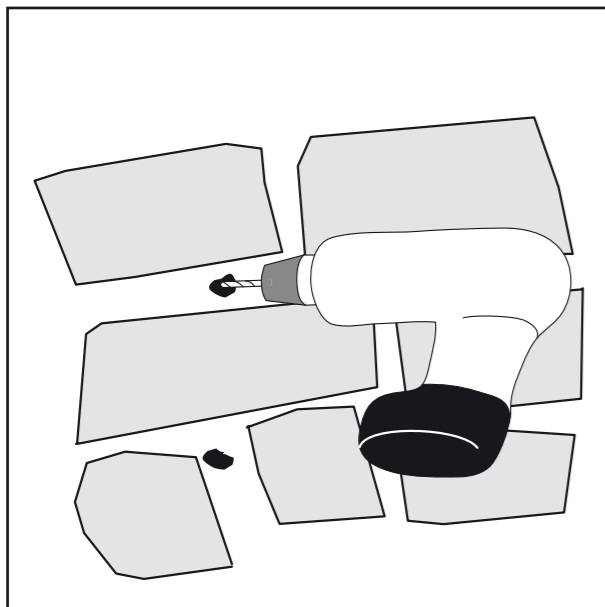

Drill the holes in the mortar.

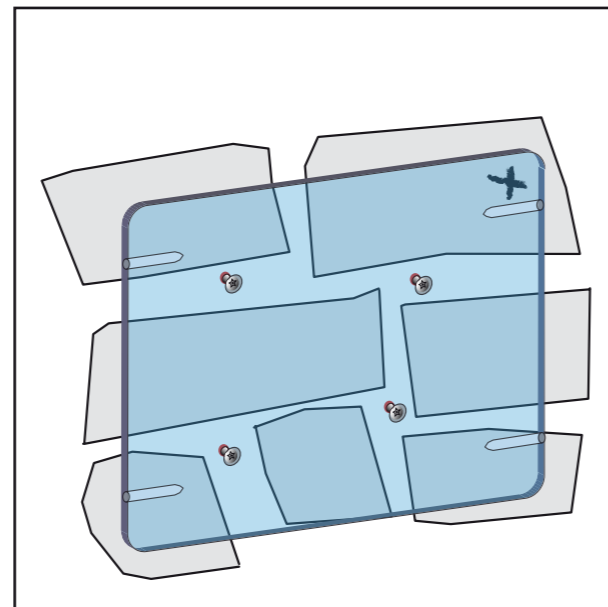

Fix the acrylic with bolts and plugs suitable for the mortar depth. If the wall is very rough pin the acrylic off slightly with plastizote spacers. Do not twist the acrylic.



Fit the sign front back over the acrylic and secure it in place with the security screws.