

NOTE

This drawing is copyright and must not be reproduced in whole or in part for any purpose without the Architect's permission. It is based on surveys by others and no responsibility is accepted for accuracy. It must be read with the rest of the Contract documents and errors and omissions must be notified to the Architect before work is commenced or orders placed. The design is provisional and to be confirmed after full site investigations.

No.	Revision/Issue	Date

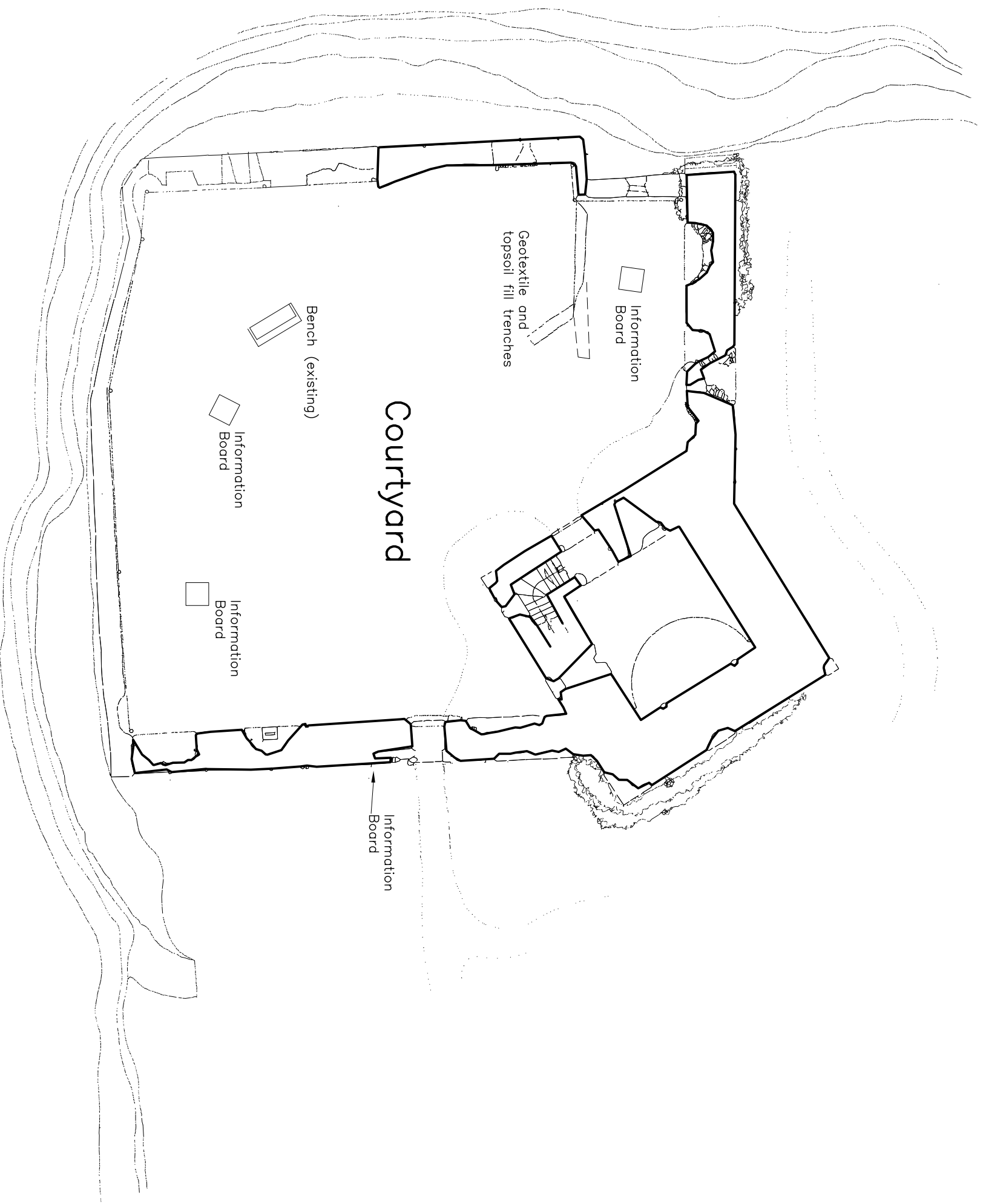

Information Boards to be plug and screw fixed into joints or fixed on slabs / boulders without any ground disturbance.

Project Dunollie Castle Conservation Works Phase 2
Client Dunollie Projects Ltd
Dunollie House
OBAN Argyll PA34 5TT

Title **Proposed
Information
Panel
Locations**

Drawing no. **422/21**

Date 5 April 2016

Scale app. 1:200 @A3

Autocad ref. 422prog2015.dwg